

PRODUCT MANUAL

ALPB series Progressive Lubrication pump



AUTOL

Index

Declaration of incorporation	3
Legal disclosure	4-5
Safety instructions	5-7
Lubricant	7
Technical data	8-30
Overview	9
Working Principle	10
Pump element	11-12
Safety valve SV - C / SV - A	13-15
Installation dimensions	16
Low level indication	17-18
Integrated Controller and Monitoring	19-23
Internal and external wiring connections	24-32
Filling of the pump	33
Explosion Drawing and General BOM	34-48
Delivery, returns and storage	49
Installation	50-51
Trouble shooting	52
Shutdown and disposal	53
Order key	54

Declaration of incorporation

Declaration of incorporation for incomplete machinery (acc. To EC-directive 2006/42/EG)

The manufacturer: Zhengzhou Autol Technology CO.,LTD., Hehuan Rd, 96, Zhengzhou High-Tech Zone, China
declares hereby, that the following fully completed machinery:

Designation: Centralized lubrication pump
Type: ALPB
Part No.: 20xxxxxxxx

is complying with all essential requirements of the above-mentioned machinery directives (2006/42/EG):
Annex I, article 1.1.2, 1.1.3, 1.1.5, 1.3.2, 1.3.4, and 1.5.1.

The following coordinated standards have been used:
DIN EN 809
DIN EN ISO 12000

The following other specifications and standards have been used:

VDE 0530

The protection targets of the directive for have been electric equipment 2006/95/EG observed according to the annex I, no. 1.5.1 of the machine directive.

The incomplete machine may only be put into service as soon as there has been stated that the machine, into which the incomplete machine shall be installed, responds to the determinations of the machine directive (2006/42/EG).

The special documentation that responds to the machine, has been prepared according to annex VII-part B.

The manufacturer (documentation department, phone +86 400 6836 862, email: info@autol.net) obliges itself to pass on electronically the special documentation for partly completed machinery to individual national authorities upon request.

Zhengzhou, 01.10.2022

Teddy
General Manager

Zhengzhou Autol Technology CO.,LTD.

Legal disclosure

Manufacturer

Zhengzhou Autol Technology CO.,LTD
 Add: Hehuan Rd, 96, Zhengzhou High-Tech Zone, China
 E-Mail: info@autol.net
 Website: www.autolgroup.com

Training courses

In order to provide a maximum of safety and economic viability, Autol Technology carries out detailed training courses. It is recommended that the training courses are attended. For more information, please contact Autol Technology.

Copyright

© Copyright Zhengzhou Autol Technology CO.,LTD All rights reserved.

Warranty and extent of warranty



Unauthorised intervention will rule out your warranty claim!

Warranty regarding operational safety, reliability and performance of the lubricating pump is only accepted by the manufacturer under the following conditions:

- Assembly, connection, setting, maintenance and repair are carried out by authorized and specialized staff.
- The limits stipulated in the technical data must never be exceeded.
- Only original components or components approved by the manufacturer may be used for repair and maintenance work.

All guarantees and warranties expire for damages to central lubrication systems that are caused by operation with improper lubricants (e.g., piston wear, piston jamming, plugins, embrittled sealings).

Autol Technology does not assume liability on damages caused by lubricants, even if these lubricants have been tested and released by specialized laboratory, as damages caused by lubricants (e.g., by expired or improper stored lubricants, batch variations etc.) can not be retraced to their root cause in retrospect.

Service address

Hehuan Rd, 96, Zhengzhou High-Tech Zone, China
 Tel.: +86 400 6836 862
 E-Mail: info@autol.net

Explanation of symbols



Safety instructions which, if not complied with, may endanger persons, are marked specifically with the general hazard symbol:



This heading is used if inaccurate compliance or non-compliance with the Operating Instructions or specified work procedures etc. may result in damage



Points out Special Information

Disclaimer

The manufacturer shall not be held responsible for damages caused by:

- Non appropriate use faulty assembly, operation, setting, maintenance, repair or accidents
- Use of inappropriate lubricants
- Improper or late response to malfunctions
- Unauthorized modifications of the product
- Intent or negligence
- Use of non-original Autol Technology spare parts
- Faulty planning or layout of the centralized lubrication system

Liability for loss or damage resulting from the use of our products is limited to the maximum purchase price. Liability for consequential damages of whatever kind is excluded

Safety instructions

General information

Any safety-related faults must be eliminated without delay.

Below, please find fundamental instructions to be complied with, regarding assembly, operation and maintenance. The mechanical and the competent specialists / staff of the operating company must read the Operating Instructions on all accounts prior to starting assembly and commissioning. Moreover, the Operating Instructions must permanently be available on site.

Not only the safety instructions included under this item, but also the specific safety instructions appearing in other parts of this manual must be complied with.,

General risk reference

All system components have been designed in view of operational safety and accident prevention according to the applicable provisions for the design of technical equipment.

Nevertheless, utilization thereof may result in risks for the user or third parties and/or technical equipment. Thus, the system may only be used in proper technical working within its intended fields of application and in compliance with the safety provisions and the Operating Instructions.

Personal:

The staff in charge of operation, maintenance, inspection and assembly must be qualified accordingly for this work. The operating company must stipulate competences, responsibilities and the supervision of staff precisely. If the staff does not dispose of the appropriate knowledge, they must be trained and instructed. The operating company must ensure that the staff have understood the contents of the Operating Instructions.

Danger due to non-observance of the safety information



Non-compliance with the safety information may put persons at risk and endanger the environment and/or the machine. Non-compliance with the safety instructions may rule out any claims for damages.

Non-compliance may lead, e. g. to the following dangers:

- Failure of important system functions,
- Failure of the specified maintenance and servicing methods,
- Endangering people due to electrical, mechanical and chemical effects,
- Endangering the environment due to leakages of dangerous materials.

Use in conformity with the intended purpose:

The pumps of the series ALPB serve only for the supply of central lubrication pumps at vehicles, systems and machines. Any use beyond this scope is regarded as being not in conformity with the intended purpose.

Assembly and maintenance



Observe for all assembly works at vehicles, systems and machines the valid local accident prevention regulations and safety instructions as well as the specifications for operation and maintenance.

All maintenance, inspection and assembly work may only be carried out by trained specialists. All work must only be carried out when the plant is at a standstill and while wearing appropriate protective clothing.

All the safety and protective equipment must be replaced immediately after completing work. Materials that endangers the environment must be disposed in accordance with pertinent official specifications. Secure the system during maintenance and repair works, against intentional or unintentional reoperation.

Dispose of process materials in accordance with the safety data sheets of the lubricant manufacturer.

Safety information for operators/operating staff



- If hot or cold machine parts led to hazards, the customer must secure them from being touched. The guards on moving or rotating parts must not be removed.
- Drain leakages of dangerous materials in a way, that people or the environment are not endangered.
- Comply with legal regulations.
- Exclude any hazards by electric energy.

Unauthorized modification and spare part production



Modifications and alterations of the system require the manufacturer's prior approval. Original spare parts and accessories authorized by the manufacturer serve for higher safety. The use of other parts may rule out liability for the consequences of such use. For components, which are retrofitted by the operator, Autol Technology does not assume liability nor claims for compensation.

Danger caused by the electrics



The units may be connected to the power supply exclusively by appropriately trained qualified personal in conformity with the local connection conditions and regulation (e. g. DIN, VDE)!

Improperly connected equipment may lead to serious personal injury and damage to property!

AUTOL

Danger caused by system pressure



The units might be under pressure. Make them pressure less before you start with repairs, changes or extensions.

Use of hydraulic hose lines:



Installing hydraulic hose lines at the pump, the operator must observe respectively ensure the following items:

- Checks for proper assembly and function must be carried out according to the regional valid guidelines.
- Checks for a safe provisioning and use must be carried out according to the regional valid guidelines.
- The check deadline must not be exceeded.
- Exchange defect hydraulic hose lines immediately and professionally.
- Hydraulic hose lines subjected to a wear process and must be exchanged regularly and according to the manufacturer's details.

Cleaning

The pump has an IP69 protection rating! It is not allowed to clean the Autol Technology pumps with a high-pressure washer. The high-pressure spray can allow water to penetrate the seals into the pump. We do not provide a warranty when high-pressure washers are used!



Lubricant

The system has been designed for commercially available multi-purpose greases of NLGI class 2 for operation in summer and winter.

- Use greases with high-pressure additives (EP greases).
- Only use greases of the same saponification type.
- Lubricants containing solid contents must not be used (lubricants like graphite or MoS₂ on request).
- Observe the vehicle manufacturer's specifications, when you select the lubricant.



Hazards to environment caused by lubricants

The lubricants which are recommended by the manufacturer of your vehicle, system or machine correspond in their composition to the common safety regulations. Mineral oils and greases are generally hazardous to ground water and their storage, processing and transport requires special precautions.

Inadmissible methods of operation



Operational security of the plant is only guaranteed if it is operated in accordance with the operating instructions. The limit values stated in the technical data must not be exceeded under any circumstances.

Transport and storage of the pump

The pumps of the series ALPB are packed commercially, according to the regulations of the recipient country and to the wish of the customer. There are no limitations with respect to land, air or sea transport. Store in a dry place at a temperature of -5° C to +35°C.

Technical data

Overview

Autol Technology progressive centralized lubrication pump type - ALPB has been widely used in industries like wind power, mining, metallurgy, machine tools, textiles, food, ports, commercial vehicles, construction machinery, and heavy mechanical equipment, etc.

Our Autol Technology automatic lubrication system lubricates all lube points as required through progressive lubrication system. It can reduce the friction resistance, reduce contact wear and decrease the friction surface temperature. Meanwhile, it plays a supporting role of anti-rust, shock absorption and sealing.



*Dia. 11.1 System Layout for
ALPB Progressive Lubrication Pump + JPQ1 Progressive Dividers*

Overview

The Autol Technology progressive central lubrication pump type - ALPB is electrically operated and has up to a max. 4 independently operating lubricant outlets, which can be engaged by bypasses. A separate pump element PE is required for each outlet. Three different delivery rates are available. This allows the grease quantity to be metered precisely for the requirements of the individual progressive distributor layouts.

These pumps enable the delivery of lubricants up to NLGI-Class 2 at a working pressure of maximum 350 bar (adjusting of Safety Valve SV).

The ALPB series pumps differ in reservoir size and control type. It can be controlled by the standard integrated controller with current version AK09* with LED display AK06, or externally by PLC, board computer or external controller from Autol Technology.

** The standard integrated controller's version might be upgraded by Autol Technology, please check with us for the latest version if necessary.*

Technical data:

Motor:			
Operating Voltage:	12V DC ±10%	24V DC ±10%	230V AC ±10%
Revolutions[rpm]:	20 ± 2	23 ± 2	23 ± 2
Relative duty cycle:	30% ED S3 30 minutes		
Current consumption at +20°C:			
Idling:	1A	0,6A	0,12A
Full load:	5A	3A	0,62A
Fuse:	10A	6A	6A

Attention: The pump must be protected by a backup fuse in front of the pump to avoid overvoltage damage!



Pump:	
Max. number of pump elements:	4
Max. Operating pressure:	350 bar
Preset pressure of safety valve:	300 bar
Permissible operating temperature:	-35°C to +70°C
Sound pressure level	<70 dB
Reservoir size:	2/4/8/15/20/30 L
Mounting position:	Vertical(All specifications), Install at any angle(4/8/15/20/30L pump with spring platen)
Protection type:	IP69 as per ISO
Lubricant:	Greases up to NLGI- Cl.2 No grease with solids, no oil



Dia. 12.1 Pump with 2/4 liter Reservoir - Outside Diameter of Reservoir : 170 mm



Dia. 12.2 Pump with 4/8/15/20 liter - Outside Diameter. of Reservoir : 230 mm

Pump with 20/30 liter - Outside Diameter. of Reservoir : 314 mm

AUTOL

Working Principle

A gear DC motor (9) continually operates eccentric pressure disc (5). This eccentricity effects the suction and pressure strokes of the delivery piston (6), whereby the integrated non-return valve (7) prevents the delivery media from being sucked back out of the main line.

The stirrer (2) pushes the lubricant out of the grease reservoir (1) through a screen (4), which reduces any air bubbles, to the suction area in the pump body (3). The stirrer (2) enables a visual check of the lubricant volume still present in the transparent supply container (1).

The safety valve is pre-set to 300 bar.

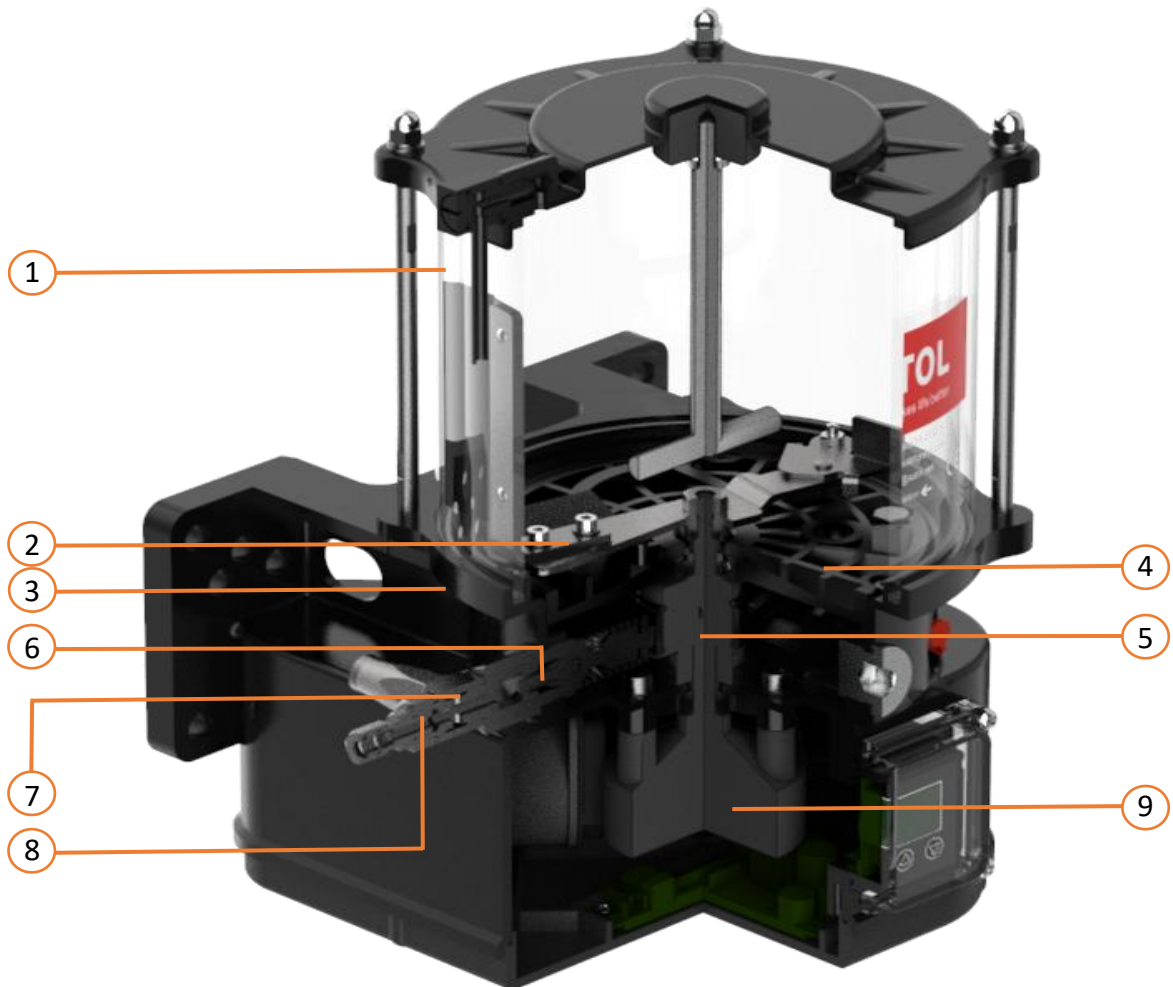

Dia. 13.1 Pump working principle

1. PC Grease reservoir
2. Stirrer
3. Aluminium Pump body
4. Perforated plate
5. Eccentric pressure disc
6. Delivery piston
7. Non-return valve
8. Safety valve
9. Motor

Pump Element

ALPB series pumps can be installed:

- max. 4 pump elements with type C safety valve (SV-C without bypass) on the pump outlet position 1/2/3
- or
- max. 3 pump elements with type A safety valve (SV-A with bypass) on the pump outlet position 1/3*.

* More possibilities for customized Pump Elements setting please contact us.

Pump elements can deliver the grease separately with the flow rate range between 1.5 - 4.5 cm³/min or bridge with each other to achieve a higher flow rate till 13.5 cm³/min with SV-A safety valve or till 18 cm³/min with SV-C safety valve*.

* For more information of pump elements bridge please contact us.

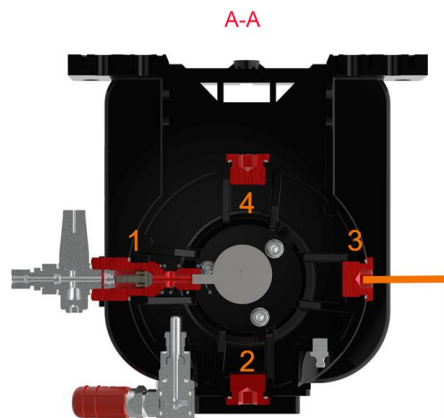

Dia. 14.1 Pump outlets position

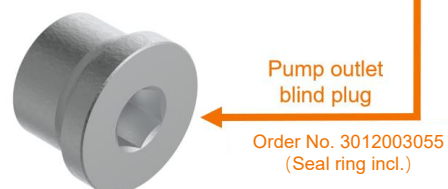

Technical Data Pump Element (without safety valve):

	Fixed delivery quantity (cm ³ /min)	Order No.	Connecting thread
PE 1.5	1.5	2031001118*	M22x1.5
PE 2.5	2.5	2031001119*	M22x1.5
PE 4.5	4.5	2031001120*	M22x1.5

* Order No. for PE1.5/2.5/4.5 includes Copper Ring already, but without safety valve.

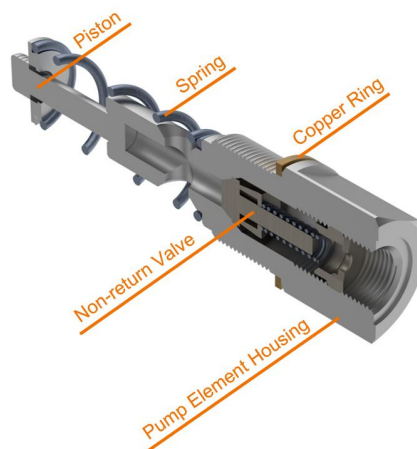

Dia. 14.2 Pump Element structure

AUTOL

Pump Element

Function of Pump Element

On the vertical shaft of the geared DC motor an eccentric pressure disc EPD with eccentric hole in the centre is mounted. When the pump starts running the EPD will make a back-and-forth movement (X_1 , X_2 , X_3). The pump element is mounted in the pump body the piston of the pump element will run against the EPD.

When the EPD is moving away from the piston (*Dia. 15.1-1*) the spring on the pump element will push the piston against the EPD. In this suction stroke grease is sucked into the pump element through the 2 suction holes.

See the 2 arrows in (*Dia. 15.1-1*). The vertical shaft will continue rotating and the EPD will push the piston into the other direction (*Dia. 15.1-2*). In this pump stroke the piston will close the 2 suction holes and pushes the suctioned grease to the non-return valve.

The pressure created by the piston and grease will open the non-return valve (*Dia. 15.1-3*) and the grease flows to the outlet of the pump element further into the lubrication system.

Pump Element Installation and Removal

1. Insert the pump element vertically into the pump outlet housing drilling (*Dia. 15.2*).
2. Tighten the pump element clockwise with a torque wrench, the pre-set value of the torque wrench can not be less than 43 N/m* (*Dia. 15.2*).

* Value is default setting by original manufacturer.

3. For removal, reserve above sequence.

Only install or remove the pump element when pump power OFF!!!

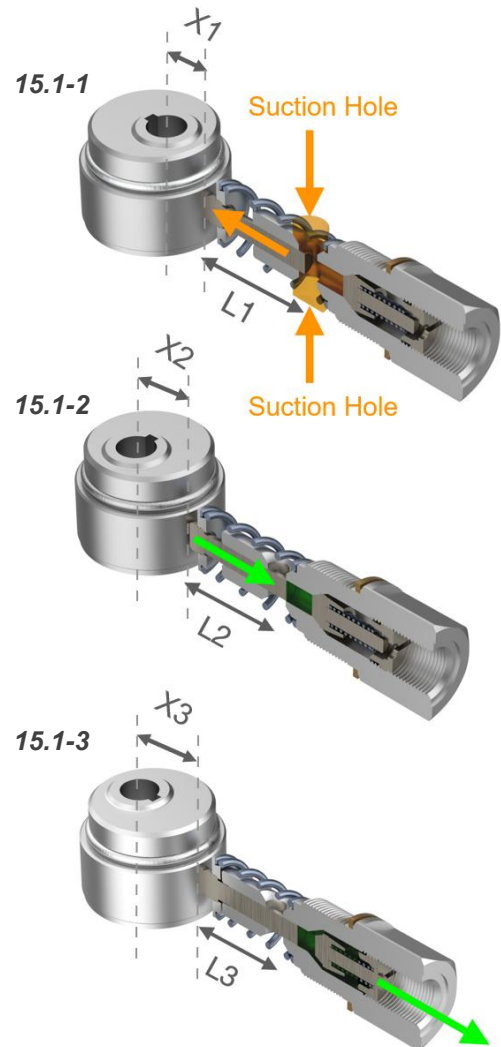

Dia. 15.1 Pump Element Working Principle

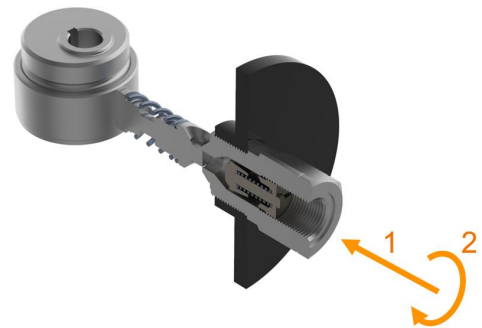

Dia. 15.2 Pump Element installation and removal



AUTOL

Safety Valve Type C: SV-C for PE (Standard Version)

Safety valve Type C: without bypass function
 Safety valve Type C: Pre-set to 300 bar

When the system pressure is higher than the pre-set valve (300 bar), the safety valve opens, lubricant flows from the safety valve overflow port out.

Please consider the relevant environmental conditions!

Order No. with Safety Valve Type C

	Option	Order No.
SV-C*	/	2031001116
Straight Coupling*	LL6	3012002826
	L8	3012003039
Copper Ring	/	3014000576

* For SV-C Order No. 2031001116 already includes the copper rings. For extra Copper Ring Order No. is 3014000576.

* For further information to hose couplings like swivel type or elbow type please check our accessories catalog or contact us.

The default setting by the original manufacturer for the torque value between safety valve and pump element is 36 ± 2 N/m.

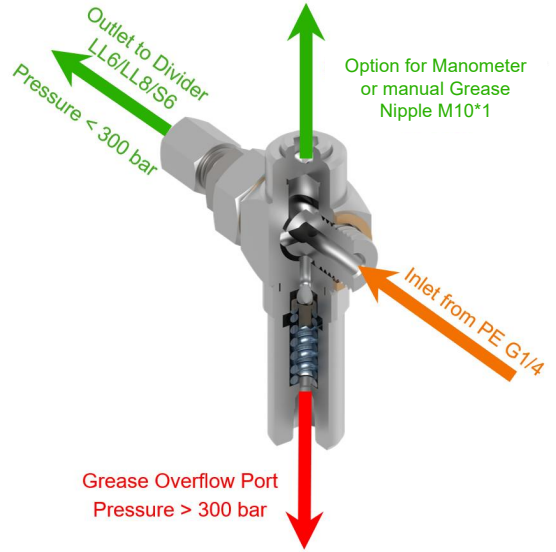

Dia. 16.1 Safety Valve C Working Principle

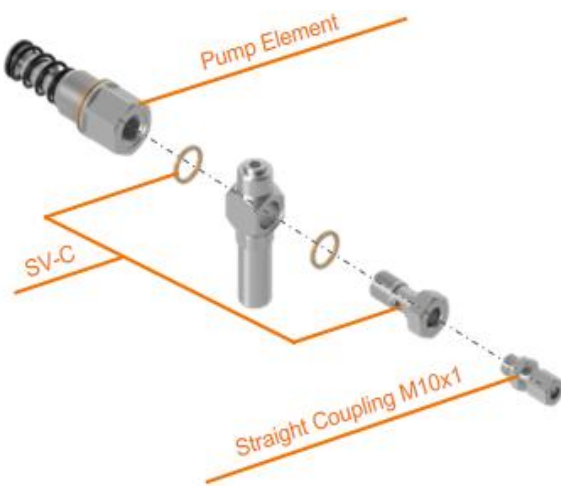

Dia. 16.2 Explosion for SV-C with PE + Straight Coupling

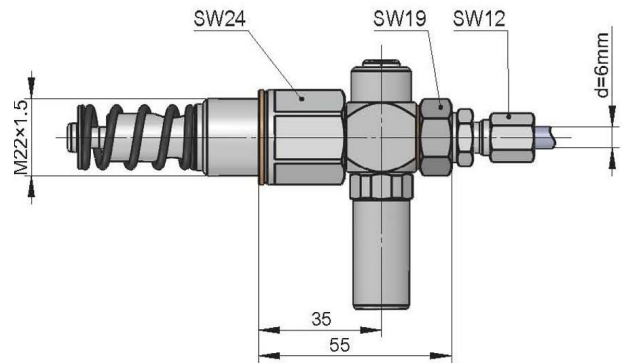

Dia. 16.3 Installation Dimensions for SV-C + PE

AUTOL

Safety Valve Type A: SV-A for PE

Safety valve Type A (SV-A): with bypass and indication pin function

Safety valve Type A (SV-A): Pre-set to 300 bar

When the system pressure is higher than the pre-set valve (300 bar), the safety valve opens, lubricant flows from the bypass of the safety valve and back to pump reservoir, indication pin moves out.

Safety valve Type A: single bypass function

Order No. with Safety Valve Type A

	Option	Order No.
SV-A*	/	2030000772
Bypass	Single bypass	2031000878
	Dual bypass	2031000619
Straight Coupling*	LL6	3012002826
	L8	3012003039
Copper Ring	/	3014000576

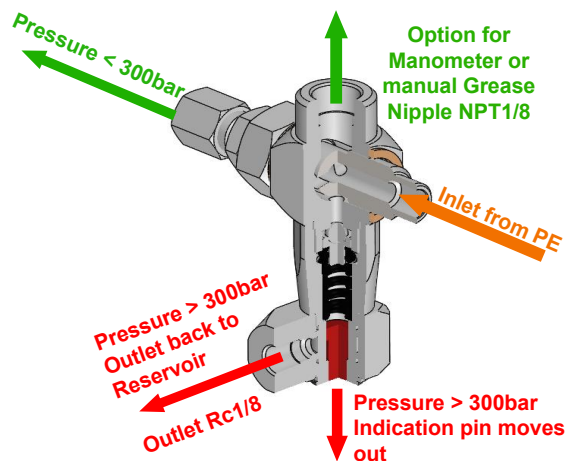

The default setting by the original manufacturer for the torque value between safety valve and pump element is 36 ± 2 N/m.



Dia. 17.1 Safety valve A working principle

* For SV-A Order No. 2030000772 already includes the copper rings. For extra Copper Ring Order No. is 3014000576.

* For further information to hose couplings like swivel type or elbow type please check our accessories catalog or contact us.

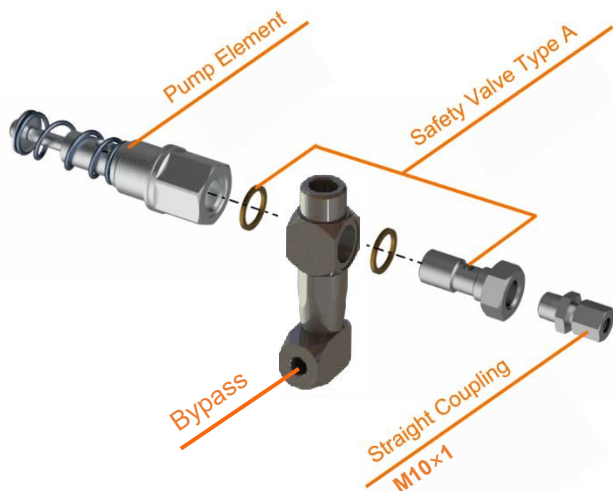

Dia. 17.2 Explosion for SV-A with PE + Straight Coupling + Bypass

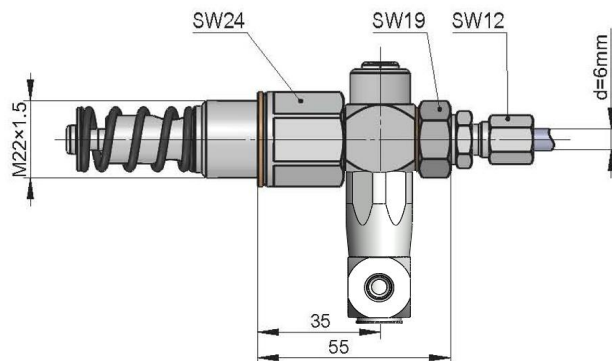

Dia. 17.3 Installation Dimensions for SV-A + PE

AUTOL

Grease Bypass Kit for Safety Valve Type A

Single Bypass (Order No. 2031000878)

In *Dia. 18.2* shows the pump with safety valve type A and single bypass, which mainly used for Windmill application.

When the pressure is higher than the pre-set max. value of the safety valve, the grease flows back through the pump element - safety valve - single bypass - pump reservoir.

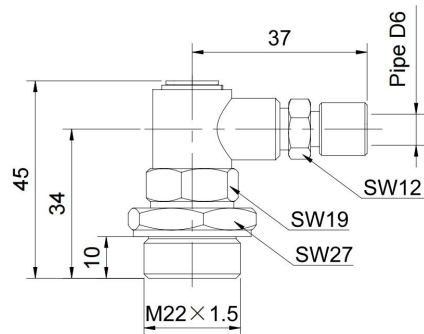

Dia. 18.1 Installation Dimensions of Single Bypass

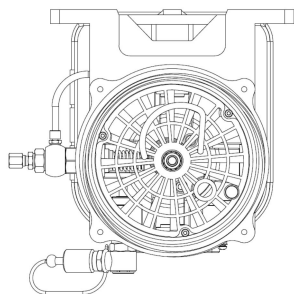

Dia. 18.2 Pump with 1 safety valve type A + Single Bypass

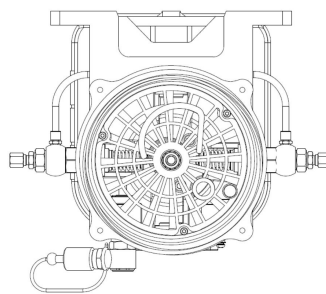

Dia. 18.3 Pump with 2 safety valve type A + Dual Bypass

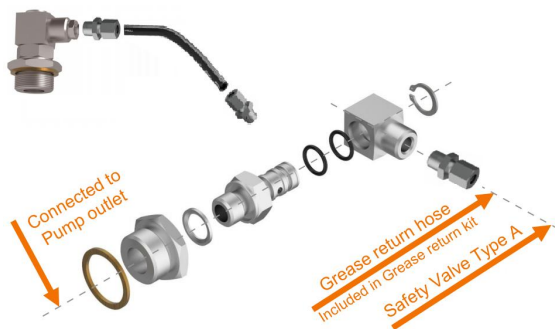

Dia. 18.4 Explosion of Single Bypass

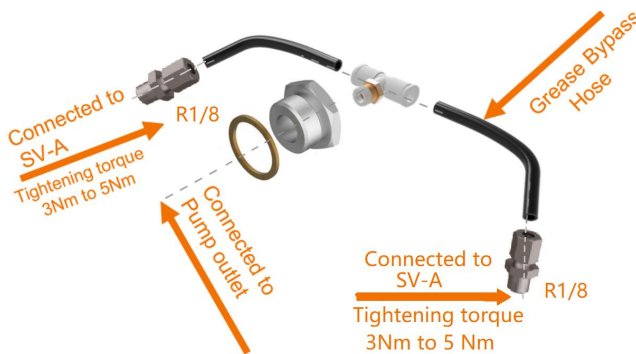

Dia. 18.5 Explosion of Dual Bypass

Dual Bypass (Order No. 2031000619)

In *Dia. 18.3* shows the pump with safety valve type A and dual bypass, which mainly used for Wind mill, heavy metal industry application.

When the pressure is higher than the preset max. value of the safety valve, the grease from the 2 pump outlets flows back through the pump element - safety valve - dual bypass and combined back to pump reservoir.

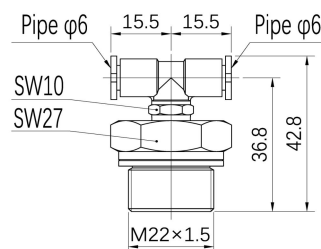

Dia. 18.6 Installation Dimensions of Dual Bypass

AUTOL

Installation Dimensions

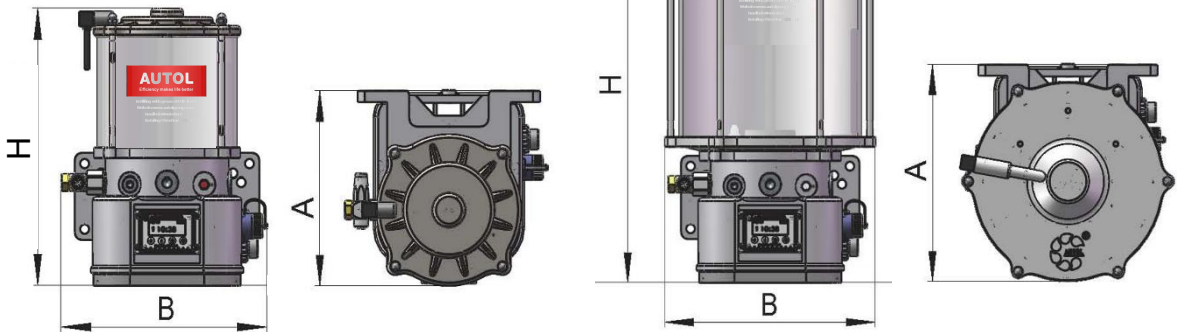

ALPB BYN/HSC D170

ALPB BYN/HSC D230/D314

Installation Dimensions for ALPB BYN/HSC Pump (Stirring Paddle and Spring Piston Type)

Capacity	2L D170	4L D170	4L D230	8L D230	15L D230	20L D230	20L D314	30L D314
A (mm)	242	242	259	259	259	259	363	363
B (mm)	235	235	265	265	265	265	343	343
H (mm)-Stirring Paddle Type-DC	317	462	350	521	636	769	/	/
H (mm)-Spring Piston Type-DC	/	/	462	566	814	1024	690	845
H (mm)-Stirring Paddle Type-AC	347	492	380	551	666	799	/	/
H (mm)-Spring Piston Type-AC	/	/	492	596	844	1054	720	875

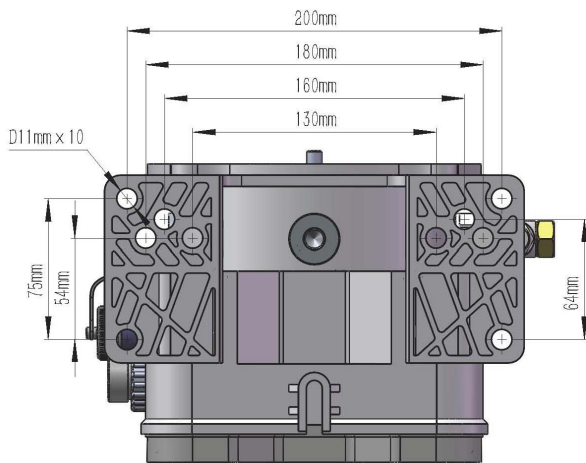

Dia. 19.2 Mounting dimensions for ALPB pump (Stirring paddle and spring piston type) - on Bottom

Mounting Dimensions for ALPB Pump (Stirring Paddle Type)

Capacity	15L	20L	30L
H1 (mm)-Stirring Paddle Type	402	545	/
C (mm)-Stirring Paddle Type	160	160	/
H1 (mm)-Spring Piston Type	545	572	727
C (mm)-Spring Piston Type	160	215	215



Dia. 19.3 Mounting dimensions for ALPB pump (Stirring paddle and spring piston type) on Top for Pump 15L ,20L and 30L.

AUTOL

Low-level Indication(Stiring Paddle Type Pump)

Functioning principle of the intermittent low-level indication

The intermittent low-level indication operates free of contact. Its main components are the following:

1. Firmly positioned magnetic switch *C* inside of the reservoir bottom
2. Flexible guide plate *E* connected to the stirring paddle *B* with a magnet *A*
3. A control curved track *D* fixed on the perforated base plate

If the reservoir is filled with a lubrication grease suitable for the intermittent low-level indication and the pump is operating, then the guide plate *E* is deflected by the resistance of the lubrication grease. Therefore, the magnet *A* connected to the guide plate *E* is moved on its inner circuit and cannot trigger a pulse at the magnetic switch *C* with its magnetic field. A control curved track *D* positively guides the magnet together with the pivoted guide plate towards the outside during each revolution. As soon as the guide plate leaves the control curved track, the lubricant's resistance pushes the guide plate together with the magnet to the inside again.

As soon as the lubricant inside the reservoir has fallen to that level that the lubricant's resistance is no more sufficient to further deflect the guide plate *E*, the magnet *A* remains on the outer circuit and can trigger a pulse at the magnetic switch *C* with its magnetic field.

The magnetic switch *C* will send out a pulse signal every time it is triggered. If the magnet *A* slides across the magnetic switch *C* more than 3 times (incl. 3 times) continuously in an operating cycle, the integrated controller of the pump will consider that the amount of grease in the pump is sufficient, otherwise, it is considered that the amount of grease in the pump is insufficient.

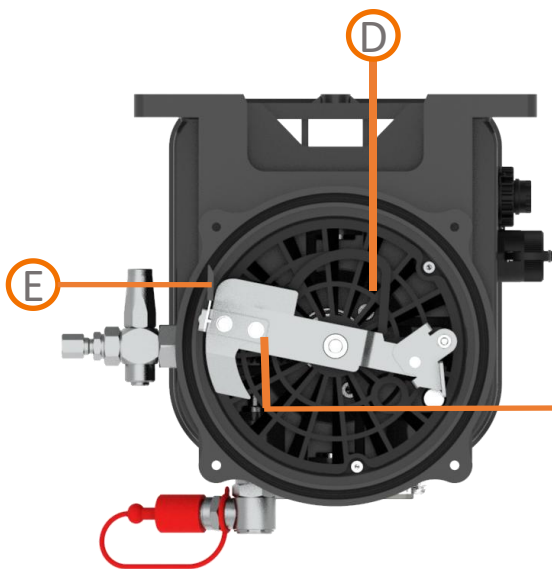

Dia. 20.1 Low level indication perspective representation

A – Magnet, B – Stirring paddle, C – Magnet switch, D – Control curved track, E – Guide plate

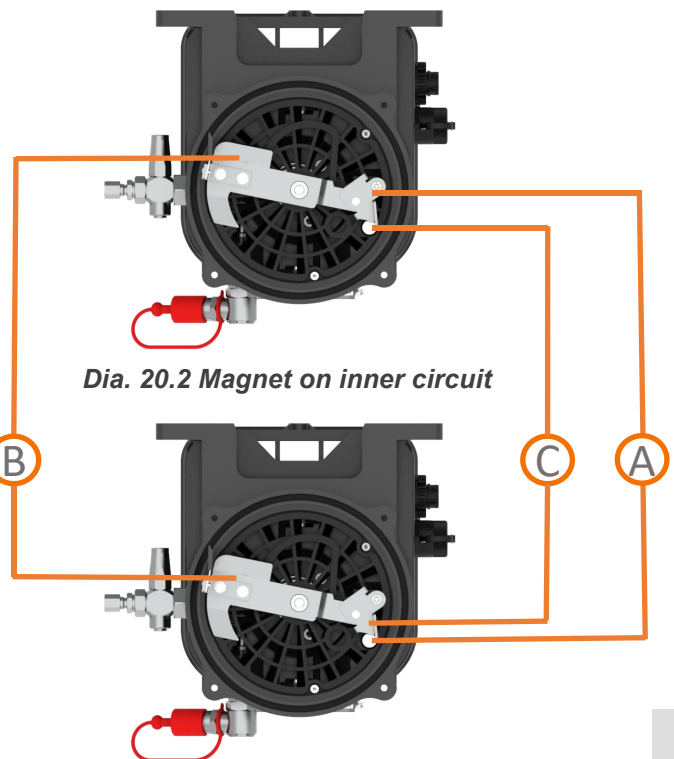

Dia. 20.2 Magnet on inner circuit

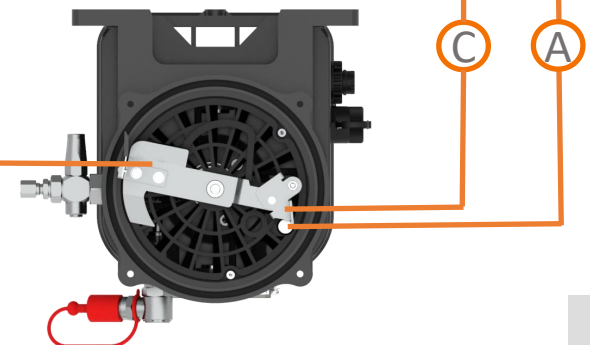

Dia. 20.3 Magnet on outer circuit

Low-level Indication(Spring Piston Type Pump)

Functioning principle of the low-level indication

The low-level indication operates free of contact. Its main components are the following:

1. The low level sensor A is installed and fixed inside the tie rod B
2. The magnetic ring D is fixed inside the piston kit C
3. The tapered spring E is tightly pressed against the bottom groove of the piston assembly C
4. Piston kit C can move vertically along tie rod B

When the grease in the reservoir gradually decreases, piston kit C moves along the tie rod B with the grease. Until it is close to the low level limit of reservoir, the low level sensor A is subjected to the magnetic field of the magnetic ring D and generates a low level signal, and the print board of the pump stops running after receiving the signal. Otherwise, it is considered that the amount of grease in the pump is sufficient. The pump is operating normally

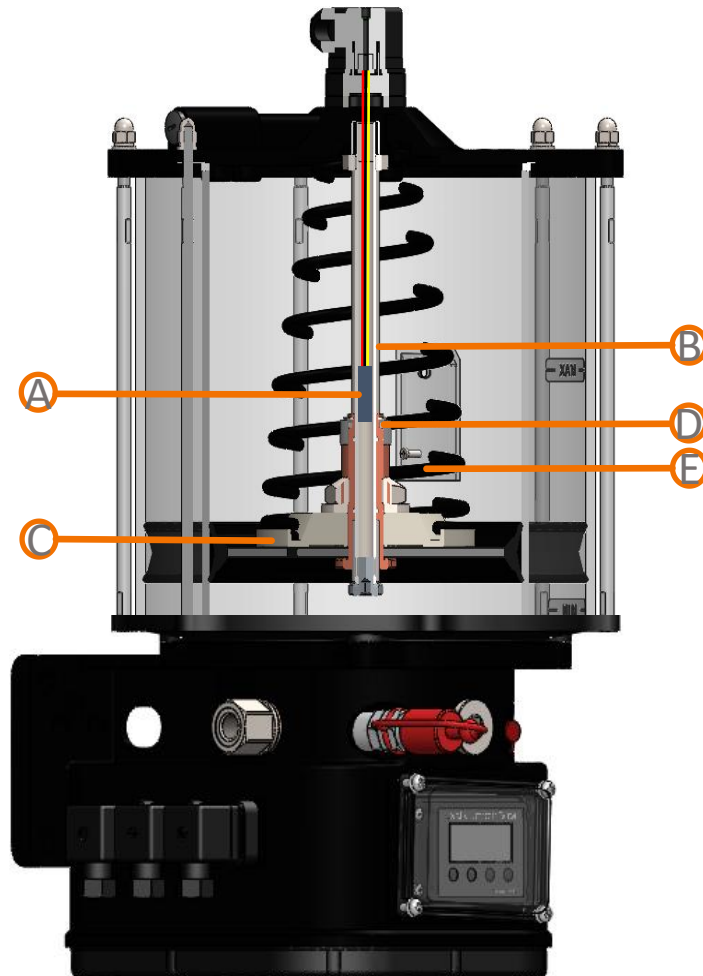

Dia. 20.4 Low level indication perspective representation

A – Sensor, B –Tie-rod, C – Piston kit, D –Magnetic ring, E-Tapered spring

LED Display AK06 with Integrated Controller AK09

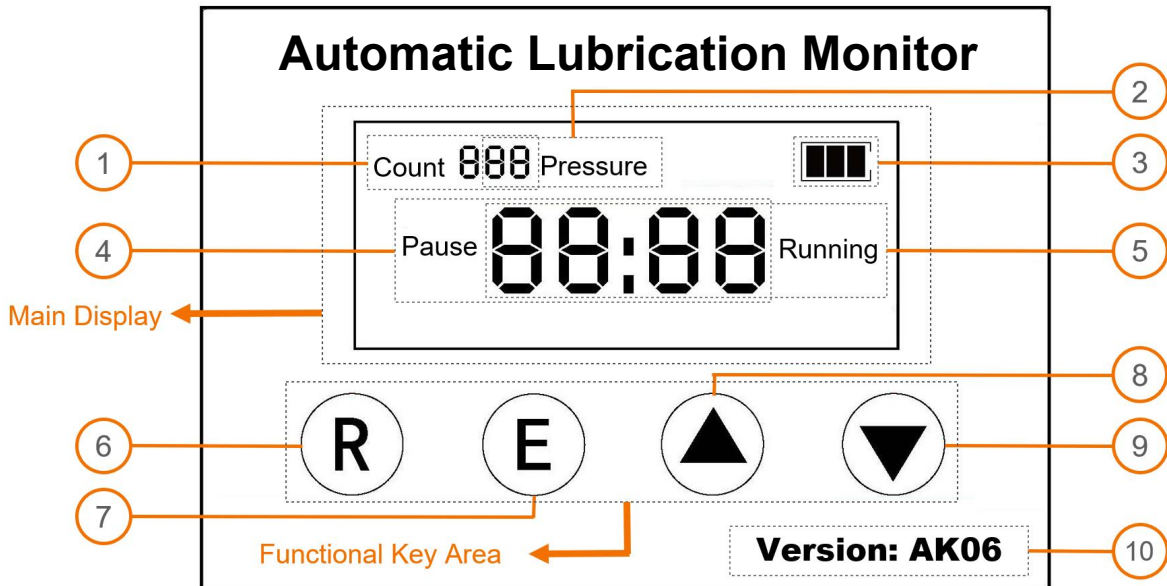

Dia. 21.1 AK06 LED- Display

Our AK09 V5.3 controller / print board is the integrated setting adjustable controller for ALPB pumps series. The AK06 LED – Monitor / Display Universal works only in combination with the AK09 Setting adjustable controller which can be programmed with different program codes depending on the type (Standard Program Code for ALPB Stirring Paddle Type Pump is d-56). (Dia. 21.1).

Main display / monitor: It shows system status like the number of finished lubrication cycles ①, divider monitoring status ②, grease level status ③, counting down pause time ④ and counting upwards lube time ⑤. If a failure is detected by the controller, the display shows the Error Code instead of pause time or lube time in main display area.

Error Code:

EE-1 Low grease level or no grease in pump reservoir, pump is under risk of empty running

EE-2 Divider monitoring status - "Failure", pump is under risk of over pressure

Very Important! - The controller has Fault Tolerance Program; the error code only starts during the second cycle after the controller gets a failure signal. After the failure has been fixed, the controller needs 2 cycles as well to reset the failure signal automatically.











Functional keys area: can adjust the pump parameters which shows on main display area, reset the lubrication cycle and clear the warning alarm.

Parameter Setting - Definition

Pos.	Parameter Description	Adjustable Range / Unit
1P	Pause Time	0 to 99 hrs and 0 to 59 mins Min. 1 min / Max. 99 hrs and 59 mins
2P	Divider Monitoring - Impulse cycles	0 to 99 impulses cycles 0 means system does not detect the impulse
3P	Lube Time	0 to 99 mins and 0 to 59 secs Min. 1 sec / Max. 99 mins and 59 secs
4P	Low Temperature setup	From -50 to 0 Celsius Degrees adjustable

LED Display AK06 with Integrated Controller AK09

Function and Display

Pos.	Sign	Description
1	Count 888	Cycles Counting: During the pause time 1P, POS. 1 shows the number of finished lubrication cycles. The value of Count adds 1 after a full lube time. E.g., Count 168 means the system finished 168 lubrication cycles.
2	88 Pressure	Divider Monitoring: During the running time 3P, 2 shows the impulse of the divider monitoring. OFF Pressure means controller is counting the detected impulse cycles from the divider monitoring. The Sign turns into ON Pressue after the preset value of impulse cycles from the divider has been detected. Main display turns into EE-2 , and you can hear an alarm for 30 seconds, if the controller has not detected the preset value of impulse cycles during the lube time.
3		Grease Level:  Grease level - Full. Pump grease level is above the minimum level, the pump will work under normal status according to the preset configuration.  Grease level - warning. Pump works under the risk of low grease level. An immediate grease refilling is recommended here.  Grease level – low. Pump detected low grease level status. During the automatic cycle, the pump stops immediately no matter it reaches the preset running time or not. Error EE-1 will appear on the monitor until the pump is refilled. Push E to clear the warning alarm. Special conditions: If after the initial alarm, the pump is manually started by pressing the R button from the display, then the pump will do a complete greasing cycle according to the value set at 3P setting. The alarm for EE-1 will engage after the cycle finishes. If the pump is manually restarted using the test button, the consequence will be followed same as automatic cycle.
4	Pause 88:88	Pause Time: During the system pause time 1P, the main display shows e.g., ^{Pause} 10:28 for the remained actual pause time - 10 hours and 28 minutes and the time continue counting down to 00:00 and switch automatically to lube time.
5	88:88 ^{Running}	Lube Time: During the system lube time, the main display shows e.g., 01:28 ^{Running} for the actual finished lube time – 1 minute and 28 seconds and the time continue counting upwards till the preset lube time then switch automatically to pause time.
6		Reset button (Test button): Push R during the pause time, main display stops counting down the remained pause time immediately and starts a new cycle with preset lube time. Push R during the lube time, main display stops counting lube time immediately and starts a new cycle with preset pause time.
7		Setting „Enter“ button / Warning alarm clear button: For „Enter“ function, please check the details in parameter setting. Push E during the system warning or error alarm (EE-1 or EE-2) to clear the alarm.
8		Parameter setting +: Please check the details in parameter setting.
9		Parameter setting „-“: Please check the details in parameter setting. Click Down Arrow no matter during the pause time or lube time, can enter the status checking interface to check the following data: D-XX: Program Code of the pump (for ALP81 Pump regular program, XX=56) EE-X: Error Code in the last cycle X (X= 0, 1, 2) t XX: Environment Temperature is XX°C -XX: Total Cycles is XX
10	Version: AK06	Controller Version: For internal controller, AK06 is the standard version. *For more details external controller please contact us.

AUTOL

LED Display AK06 with Integrated Controller AK09

Parameter Setting – First connecting to power

For first time connecting the power on the pump, the display shows the program code “d-56” up like *Dia. 23.1* or other pump pre-set program code, depends on pump and software type.

The program code can NOT be changed! The controller has pre-set parameters which can be changed under needs by following the setup steps. Otherwise, the pump runs with the default pre-set parameter.

After program code “d-56” the controller shows 1P Pause Time and is counting down, system cycle is 0 (*Dia. 23.2*).

Parameter Setting – Setup new parameter

Press Δ and ∇ button together with two fingers at the same time over 4 seconds, then release and press **E** to enter Parameter Editing Mode.

Press Δ or ∇ button to adjust the 1P Pause Time value for hour (*Dia. 23.3*). Then press **E** button again to enter -1 (Pause Time minute parameter) setting. Press Δ or ∇ button to adjust the -1 value for minutes (*Dia. 23.4*)*.

*** 1P and -1 can not set as 00 in the same time. If 1P is set as 00, -1 starts with 01.**

Press **E** button to switch to 2P divider monitoring parameter setting - impulse cycles from 0 to 99. (*Dia. 23.5*)*.

*** For system without divider monitoring sensor (proximity switch), set 2P always as 0.**

Press **E** button to switch to 3P Lubricating Time setting. 3P in minutes and -3 in seconds (the same way of setting the parameters we describe for 1P Pause Time and -1 setting) (*Dia. 23.6* and *Dia. 23.7*)*.

*** 3P and -3 can not set as 00 at the same time. If 3P is set as 00, -3 starts with 01.**

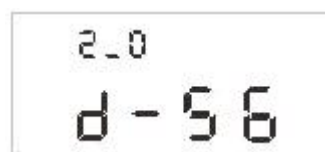

Dia. 23.1 Controller program code



Dia. 23.2 “Pause time” display after first power connection



Dia. 23.3 Setting of 1P - Pause Time in Hour



Dia. 23.4 Setting of 1P - Pause Time in Minute



Dia. 23.5 Setting of 2P - Impulse cycles



Dia. 23.6 Setting of 3P - Lube Time in Minute



Dia. 23.7 Setting of 3P - Lube Time in Second

AUTOL

LED Display AK06 with Integrated Controller AK09

Parameter Setting – Setup new parameter

Press **E** button to switch to 4P Low temperature setting. With this parameter you can stop the pump working at low temperatures. Pre-set temperature is -15°C . Press Δ or ∇ button to adjust the 4P low temperature setup. Press **E** button to confirm your new low temperature setting (Dia. 24.1)*.

*** System has a temperature sensor. In case the real temperature is under the pre-set value, the pump stops automatically to avoid the damage of motor.**

Push **E** to quit editing mode New parameter setting is done!

Display of controller during lubrication cycles

During 1P Pause Time - e.g., $\text{Pause } 10:28$, means pause time is 10 hours and 28 minutes. The Pause time is counting down wards in hours and minutes till 00:00 (Dia. 24.2), then 3P Lube Time starts counting upwards.

During 3P Lube Time -The 3P Lube Time starts counting upwards in minutes and seconds. E.g., $01:28^{\text{Running}}$, you set up 1 min and 28 seconds as lube time. it is counting upwards from 0 sec to 01 min 28 seconds (Dia. 24.3).

A complete lubrication cycles = 1 full pause time + 1 full lube time, only after a complete lubrication cycle, the count of cycles +1 on pos. 1 in Dia. 21.1.

Reset of lubrication cycle

Push **R** during the pause time, main display stops counting down the remained pause time immediately and starts a new cycle with pre-set lube time (Dia. 24.4).

Push **R** during the lube time, main display stops counting lube time immediately and starts a new cycle with pre-set pause time. (Dia. 24.5)

Push **R** always means skipping the current pause/lube time and enter into a new lube/pause time.



Dia. 24.1 Setting of 4P - Low Temperature



Dia. 24.2 Display for counting down Pause time 1P



Dia. 24.3 Display for counting up Lube time 3P

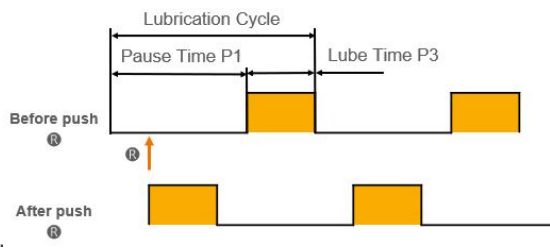

Dia. 24.4 Cycle changing when push **R** during Pause time

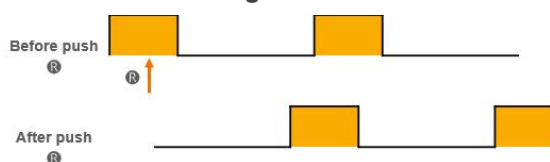

Dia. 24.5 Cycle changing when push **R** during Lube time

AUTOL

LED Display AK06 with Integrated Controller AK09

Restart of controller by switching off the machine

In case power/machine is switched off during a lube time P1 or pause time P3 following happens:

Switching machine on during 1P Pause Time, the 1P Pause time is counting down from the rest pause time where the machine was switched off (Dia. 25.1).

In case power / machine is switched off during a 3P Lubrication Time, the Lubrication time starts the full new Lubrication time which you setup (Dia. 25.2).

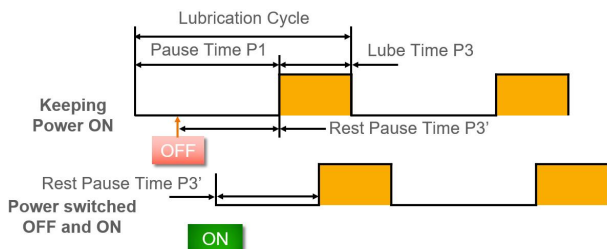

Dia. 25.1 Cycle changing when power switch ON and OFF during Pause time

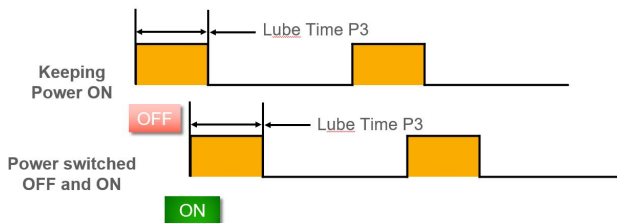

Dia. 25.2 Cycle changing when power switch ON and OFF during Lube time

More information for 2P – Impulse cycles setting with cycles sensor

2P divider monitoring, impulse cycles sensor on the divider, 2P can NOT be set as 0.

In case, the Detecting time T1, which is needed to detect the pre-set value of impulse cycles, is shorter than pre-set lube time 3P, Display turns from “OFF Pressure” to “ON Pressure” at the end of T1, Controller continues the rest lube time. After the lube time is finished, count of lubrication cycles + 1. (Dia. 25.3).

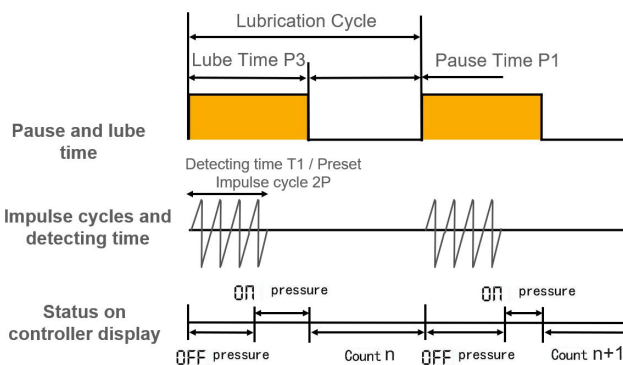

Dia. 25.3 T1 < 3P

In case the theoretical Detecting time T1, which is needed to detect the pre-set value of impulse cycles, is longer than pre-set lube time 3P, Display remains “OFF Pressure”, and shows EE-2 error message in the end of 3P and lasts for 30 secs. Lubrication cycles will not be counted. (Dia. 25.4).

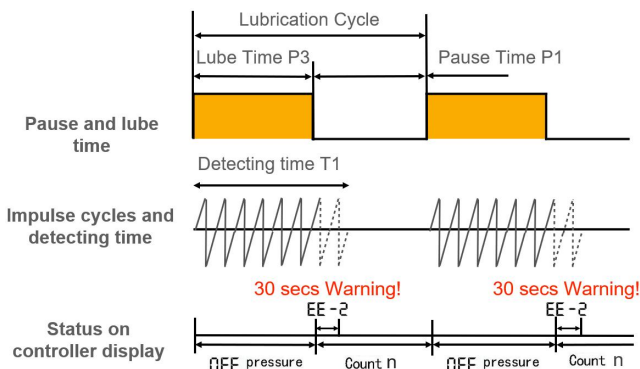

Dia. 25.4 T1 > 3P

For preset value of 3P - lube time less than 5 mins, the preset value of 2P less than 3 is recommended.

For preset value of 3P - lube time less than 10 mins, the preset value of 2P less than 5 is recommended.

The volume of grease for each greasing point only decided by 3P - lube time, not by 2P - impulse cycles.



Wiring Connection (With integrated Setting adjustable Controller AK09 V5.3)

ALPB BYN pump with 1 x BYN 7 pin connector + 1 x BD 4 pin connector – Solution for Divider Monitoring and External Test Button and Indication Light *

The power is supplied to 12 or 24V DC motor of pump via the BYN 7 pin connector from Pos. A, with an intermediate lubrication "Reset" function can be triggered by pressing a test button which is installed externally of the pump. During the lube time - 3P, test button lights "green". Button turns on "red" when the pump gets an error signal (Error code on Page 21). Button turns on "yellow" when a Reset cycle is triggered under error status.

Via Pos. B the divider monitoring 2P (proximity switch) is connected to the pump by an BD 4 pin connector.

* For more information about other solutions please contact us.

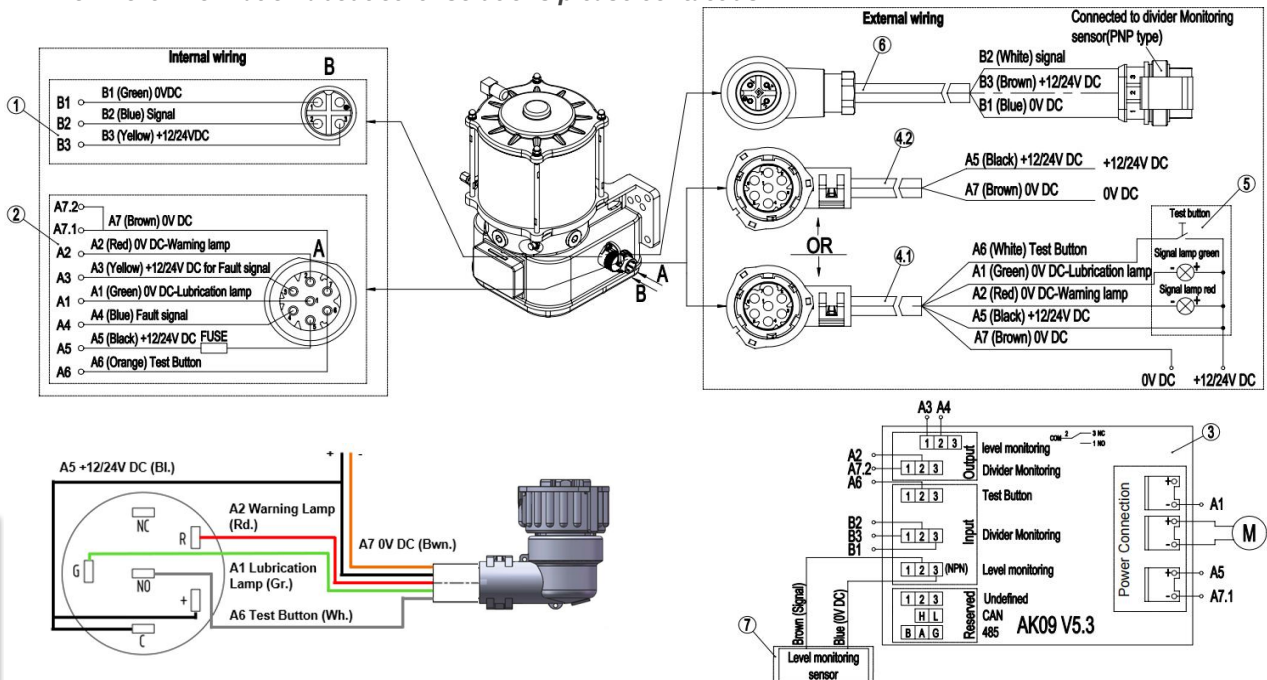

* In Dia. 26.1, it shows the pin connection for test button and indication light with Part No. 303000492 or 303000491. For warning light with Part No. 3031000197 or 3031000198 need A1 and A2. More details for the pin connection on test button and light please check the accessories catalogue.

Dia. 26.1 Wiring Diagram for ALPB BYN DC controller version

Pos.	Qty.	Description	Part No.
1	1	Wire kit-divider monitoring-12/24VDC-int.-0,3m-BD_F-4P-3xP_JSTxH_F-3x0,5	2031000104
2A	0-1	Wire kit-power supply-ALPB_BYN-12VDC-Int.-0,3m-BYN_M_7P-4xP_JSTxH_F-3xP_JSTvH_F-7x0,5	2091000053
2B	0-1	Wire kit-power supply-ALPB_BYN-24VDC-Int.-0,3m-BYN_M_7P-4xP_JSTxH_F-3xP_JSTvH_F-7x0,5	2091000051
3A	1	Controller-AK09-V5.3-programmable (print board)-program code d-56 for Stiring Paddle Type Pump	2091000054
3B	1	Controller-AK09-V5.3-programmable (print board)-program code d-01 for Spring Piston Type Pump	2091000368
4.1	1	Cable kit-power supply-12/24VDC-Ext.-7,5m-BYN-elbow connector-7 Pin-5x1,0	2210000634
4.2	1	Cable kit-power supply-12/24VDC-Ext.-7,5m-BYN-elbow connector-7 Pin-2x1,0	2210000947
5A.1	0-1	Indication light-24VDC-red-M16	3031000197
5A.2	0-1	Indication light-12VDC-red-M16	3031000198
5B.1	0-1	Illuminated push button-24VDC-green_red_yellow-M16	3030000492
5B.2	0-1	Illuminated push button-12VDC-green_red_yellow-M16	3030000491
6	0-1	Cable kit-divider monitoring-12/24VDC-Ext.-7,5m-BD_M_90_4P-APM_F_3P-3x0,5	2210000592
7	1	Level monitoring sensor-ALPB for Stiring Paddle Type Pump	2031002091

Wiring Connection (With non-Controller AK09 WK2.0)

ALPB BYN pump with 1 x BYN 7 pin connector– Solution for External Indication Warning Light *

The pump is supplied with 12/24V DC via the BYN 7-pin plug via Pos. A and the pump is not setting adjustable with lube time and pause time but controlled by power supply or external controller. The grease level indication light turns on “red” when the pump gets an error signal for the grease level.

For the non-controller version ALPB pump, it is **NOT** possible to monitor the divider status!

* **For more information about other solutions please contact us.**

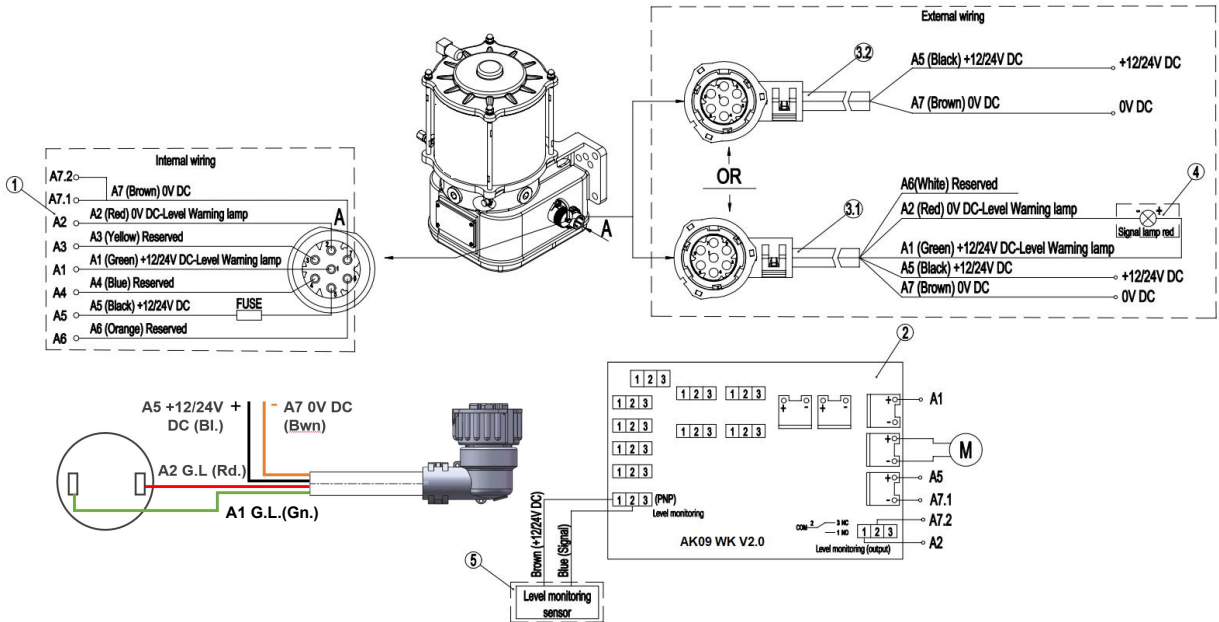

* In Dia. 27.1, it shows the pin connection for test button and indication light with Part No. 3031000197 or 3031000198.

Dia. 27.1 Wiring Diagram for ALPB BYN DC non-controller version

Pos.	Qty.	Description	Part No.
1A	0-1	Wire kit-power supply-ALPB_BYN-12VDC-Int.-0,3m-BYN_M_7P-5xP_JSTxH_F-2xP_JSTvH_F-7x0,5	2091000053
1B	0-1	Wire kit-power supply-ALPB_BYN-24VDC-Int.-0,3m-BYN_M_7P-5xP_JSTxH_F-2xP_JSTvH_F-7x0,5	2091000051
2A	0-1	Controller-AK09-WK-V2.0-12VDC-not programmable	2091000242
2B	0-1	Controller-AK09-WK-V2.0-24VDC-not programmable	2091000205
3.1	0-1	Cable kit-power supply-12/24VDC-Ext.-7,5m-BYN-elbow connector-7 Pin-5x1,0	2210000634
3.2	0-1	Cable kit-power supply-12/24VDC-Ext.-7,5m-BYN-elbow connector-7 Pin-2x1,0	2210000947
4.1	0-1	Indication light-24VDC-red-M16	3031000197
4.2	0-1	Indication light-12VDC-red-M16	3031000198
5	1	Level monitoring sensor-ALPB for Stiring Paddle Type Pump	2031002091

* Instead of divider monitoring, the function for this wire kit in non-controller version pump is for grease level warning output.

AUTOL

Wiring Connection (With integrated Setting adjustable Controller AK09 V5.3)

ALPB HSC pump with 3 x HSC 4 pin connector–Solution for Power Supply, Divider Monitoring and External Test Button and Indication Light *

The power is supplied to 12 or 24V DC motor of pump via the HSC 4 pin connector from Pos. A.

Via Pos. B the divider monitoring 2P (proximity switch) is connected to the pump by an HSC 4 pin connector.

Pos. C with an intermediate lubrication "Reset" function can be triggered by pressing a test button which is installed externally of the pump. During the lube time - 3P, test button lights "green". Button turns on "red" when the pump gets an error signal (Error code on Page 21). Button turns on "yellow" when a Reset cycle is trigged under error status.

* For more information about other solutions please contact us.

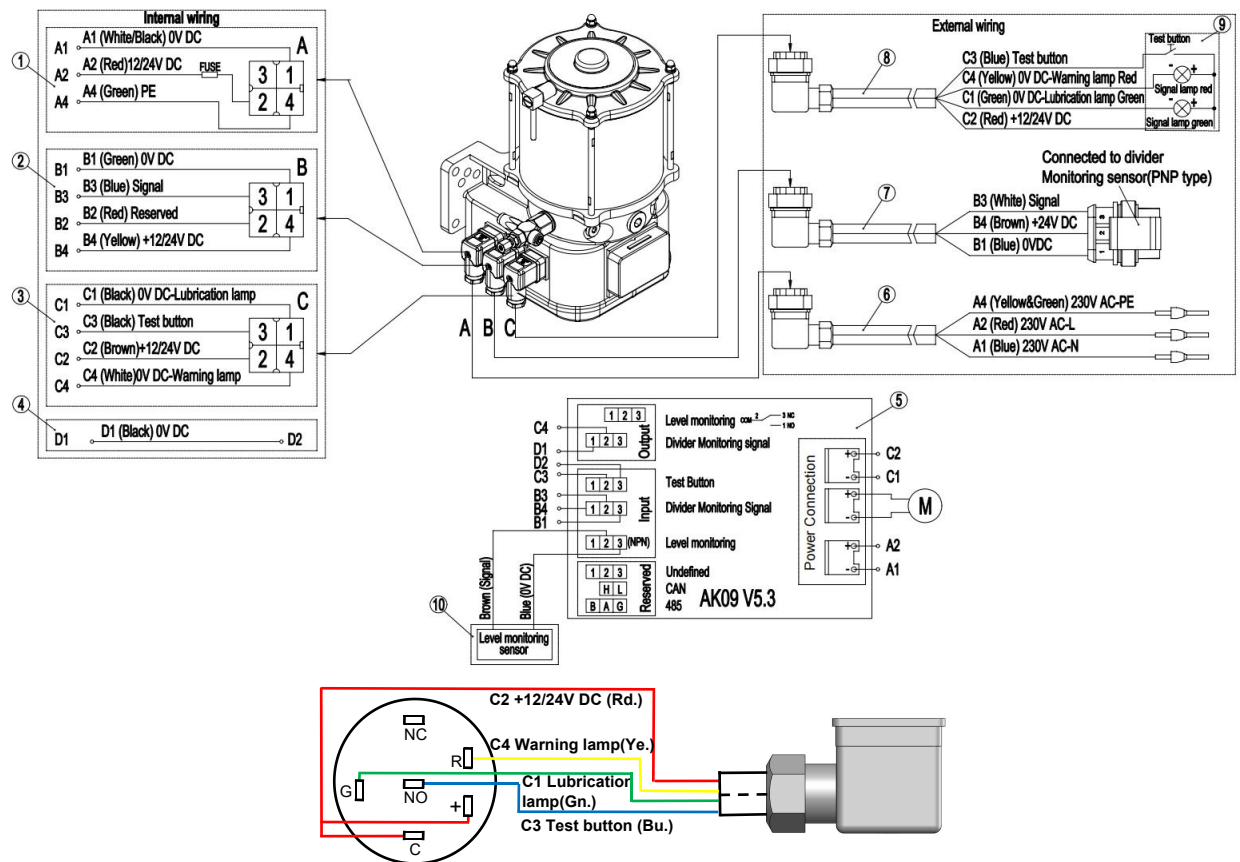

* In Dia. 28.1, it shows the pin connection for test button and indication light with Part No. 3030000492 or 3030000491. For warning light with Part No. 3031000197 or 3031000198 need A1 and A2. More details for the pin connection on test button and light please check the accessories catalogue.

Dia. 28.1 Wiring Diagram for ALPB HSC DC controller version

Pos.	Qty.	Description	Part No.
1A	1	Wire kit-power supply-ALPB_HSC-12V DC-Int.-0,3m-HSC_M_4P-3xP_SNB1.25-4_F-3x1	2031000529
1B	1	Wire kit-power supply-ALPB_HSC-24V DC-Int.-0,3m-HSC_M_4P-3xP_SNB1.25-4_F-3x1	2031000525
2	0-1	Wire kit-divider monitoring-ALPB_HSC-12/24V DC-Int.-0,3m-HSC_F-4P-3xP_JSTxH_F-3x0,5	2031000521
3	0-1	Wire kit-test button-ALPB_HSC-12/24V DC-Int.-0,3m-HSC_F-4P-2xP_JSTxH_F-2xP_JSTvH_F-4x0,5	2031000660
4	1	Double terminal line-Black	2031001206
5A	1	Controller-AK09-V5.3-programmable (print board)-program code d-56 for Stiring Paddle Type Pump	2091000054
5B	1	Controller-AK09-V5.3-programmable (print board)-program code d-01 for Spring Piston Type Pump	2091000368
7	1	Power Cable 7.5 meters - ALPB Hirschmann Connector 4 Pin-2*1-12/24V DC	2210000203
8	0-1	Divider Monitoring Signal Input Cable 7.5 meters - ALPB (H) 4 Pin - AMP 3 Pin-4P-APM_F_3P-3x0,5	2210000303
9	0-1	Test Button and Indication Light Cable 7.5 meters - ALPB (H) 4 Pin-4*0.5-24V DC	2210000351
10A.1	0-1	Indication light-24VDC-red-M16	3031000197
10A.2	0-1	Indication light-12VDC-red-M16	3031000198
10B.1	0-1	Illuminated push button-24VDC-green_red_yellow-M16	3030000492
10B.2	0-1	Illuminated push button-12VDC-green_red_yellow-M16	3030000491
11	1	Level monitoring sensor-ALPB for Stiring Paddle Type Pump	2031002091

AUTOL

Wiring Connection (With non-Controller AK09 WK2.0)

ALPB HSC pump with 2 x HSC 4 pin connector–Solution for Power Supply and Indication Light *

The power is supplied to 12/24V DC motor of pump via the HSC 4 pin connector from Pos. A and the pump is not setting adjustable with lube time and pause time but controlled by power supply or external controller.

Pos. C the grease level indication light turns on “red” when the pump gets an error signal for the grease level.

* For more information about other solutions please contact us.

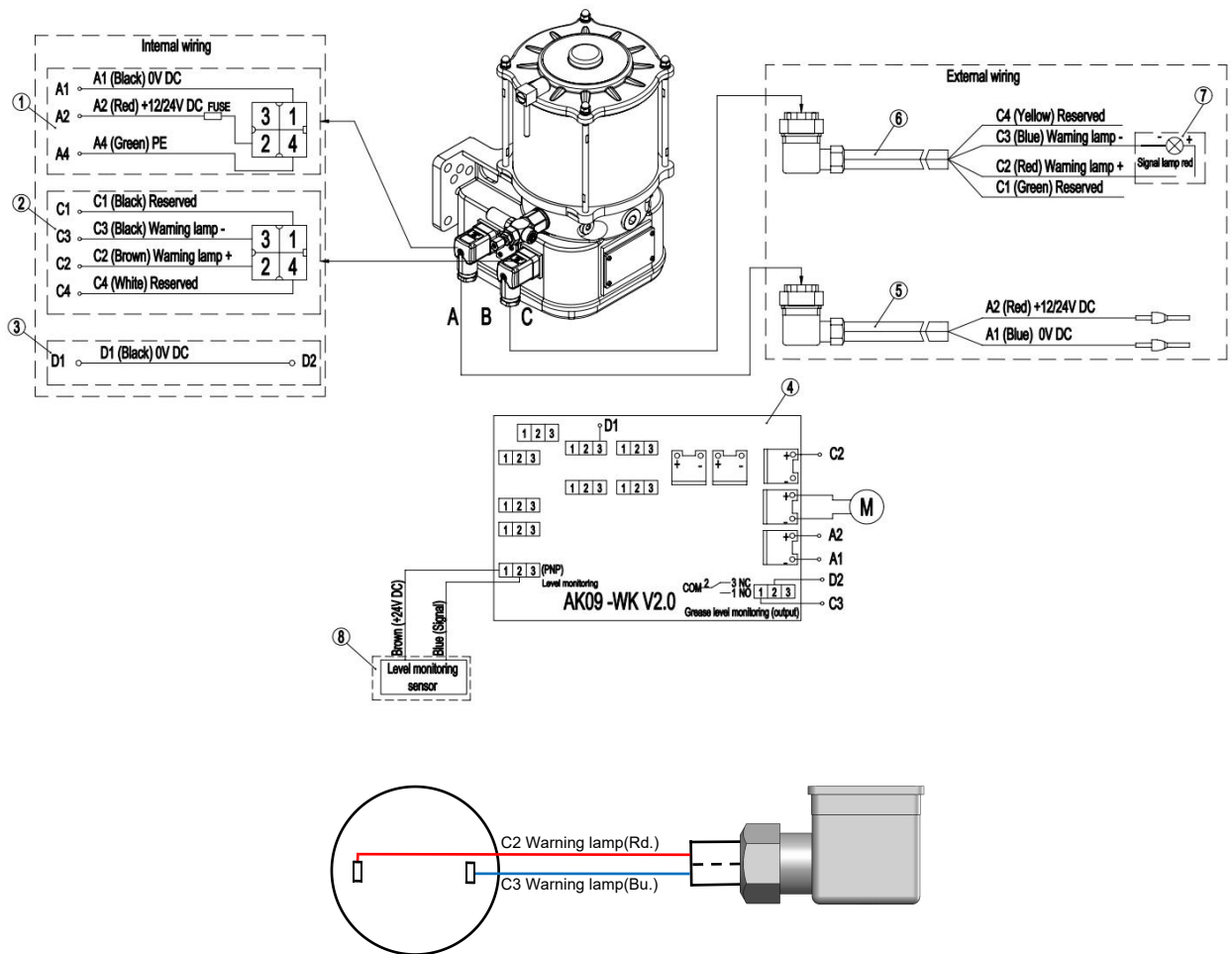

* In Dia. 29.1, it shows the pin connection for warning light with Part No. 3031000197 or 3031000198 need A1 and A2. More details for the pin connection on test button and light please check the accessories catalogue.

Dia. 29.1 Wiring Diagram for ALPB HSC DC non-controller version

* Instead of divider monitoring, the function for this wire kit in non-controller version pump is for grease level warning output.

Pos.	Qty.	Description	Part No.
1A	1	Wire kit-power supply-ALPB_HSC-12V DC-Int.-0,3m-HSC_M_4P-3xP_SNB1.25-4_F-3x1	2031000529
1B	1	Wire kit-power supply-ALPB_HSC-24V DC-Int.-0,3m-HSC_M_4P-3xP_SNB1.25-4_F-3x1	2031000525
2	0-1	Wire kit-test button-ALPB_HSC-12/24V DC-Int.-0,3m-HSC_F-4P-2xP_JSTxH_F-2xP_JSTvH_F-4x0,5	2031000660
3	0-1	Double terminal line-Black	2031001206
4A	1	Controller-AK09-WK-V2.0-12VDC-not programmable	2091000242
4B	1	Controller-AK09-WK-V2.0-24VDC-not programmable	2091000205
5	1	Power Cable 7.5 meters - ALPB Hirschmann Connector 4 Pin-2*1-12/24V DC	2210000203
6	0-1	Test Button and Indication Light Cable 7.5 meters - ALPB (H) 4 Pin-4*0.5-24V DC	2210000351
7A	0-1	Indication light-24VDC-red-M16	3031000197
7B	0-1	Indication light-12VDC-red-M16	3031000198
8	1	Level monitoring sensor-ALPB for Stiring Paddle Type Pump	2031002091

Wiring Connection (With integrated Setting adjustable Controller AK09 V5.3)

ALPB HSC pump with 3 x HSC 4 pin connector–Solution for Power Supply,Divider Monitoring and External Test Button and Indication Light *

230V AC power is supplied to the pump's 24V DC motor via the power converter via the HSC 4-pin connector at position A.

Via Pos. B the divider monitoring 2P (proximity switch) is connected to the pump by an HSC 4 pin connector.

Pos. C with an intermediate lubrication "Reset" function can be triggered by pressing a test button which is installed externally of the pump. During the lube time - 3P, test button lights "green". Button turns on "red" when the pump gets an error signal (Error code on Page 21). Button turns on "yellow" when a Reset cycle is trigged under error status.

* For more information about other solutions please contact us.

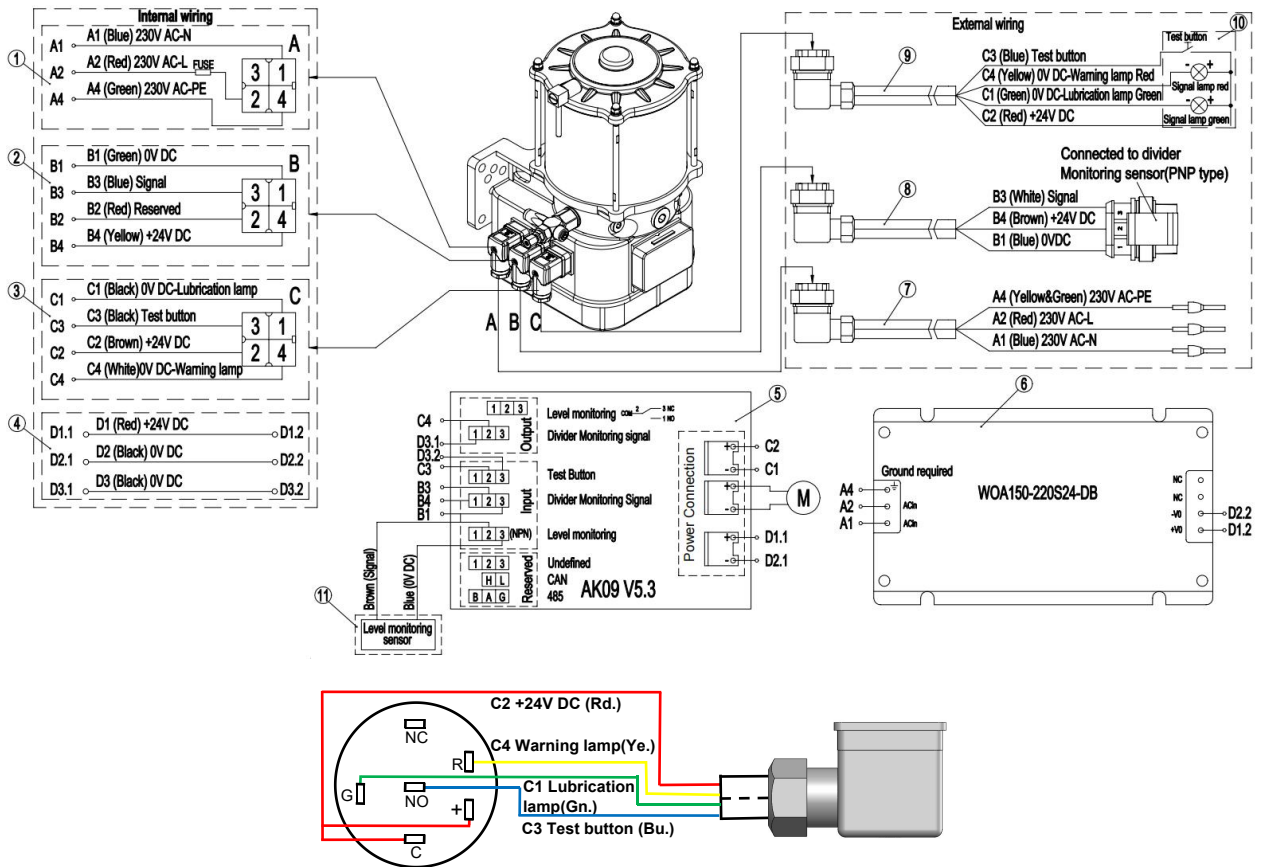

* In Dia. 30..1, it shows the pin connection for test button and indication light with Part No. 303000492. For warning light with Part No. 3031000197 need C2 and C4. More details for the pin connection on test button and light please check the accessories catalogue.

Dia. 30.1 Wiring Diagram for ALPB HSC AC controller version

Pos.	Qty.	Description	Part No.
1	1	Wire kit-power supply-ALPB_HSC-230V AC-Int.-0,3m-HSC_M_4P-3xP_SNBM1.25-4_F-3x1	2031001246
2	0-1	Wire kit-divider monitoring-ALPB_HSC-12/24V DC-Int.-0,3m-HSC_F-4P-3xP_JSTxH_F-3x0,5	2031000521
3	0-1	Wire kit-test button-ALPB_HSC-12/24V DC-Int.-0,3m-HSC_F-4P-2xP_JSTxH_F-2xP_JSTvH_F-4x0,5	2031000660
4	0-1	Wiring Set for Power Converter	2091000247
5A	1	Controller-AK09-V5.3-programmable (print board)-program code d-56 for Stiring Paddle Type Pump	2091000054
5B	1	Controller-AK09-V5.3-programmable (print board)-program code d-01 for Spring Piston Type Pump	2091000368
6	1	Pump Internal Power Converter Module 24V DC -230V AC	3030000153
7	1	Power Cable 7.5 meters - ALPB Hirschmann Connector 4 Pin-3*1-230V AC	2210000822
8	0-1	Divider Monitoring Signal Input Cable 7.5 meters - ALPB (H) 4 Pin - AMP 3 Pin-4P-APM_F_3P-3x0,5	2210000303
9	0-1	Test Button and Indication Light Cable 7. 5 meters - ALPB (H) 4 Pin-4*0.5-24V DC	2210000351
10A	0-1	Indication light-24VDC-red-M16	3031000197
10B	0-1	Illuminated push button-24VDC-green_red_yellow-M16	3030000492
11	1	Level monitoring sensor-ALPB for Stiring Paddle Type Pump	2031002091

Wiring Connection (With non-Controller AK09 WK V2.0)

ALPB HSC pump with 2 x HSC 4 pin connector–Solution for Power Supply and Indication Light *

230V AC power is supplied to the pump's 24V DC motor via the power converter via the HSC 4-pin connector at position A and the pump is not setting adjustable with lube time and pause time but controlled by power supply or external controller.

Pos. C the grease level indication light turns on “red” when the pump gets an error signal for the grease level.

* For more information about other solutions please contact us.

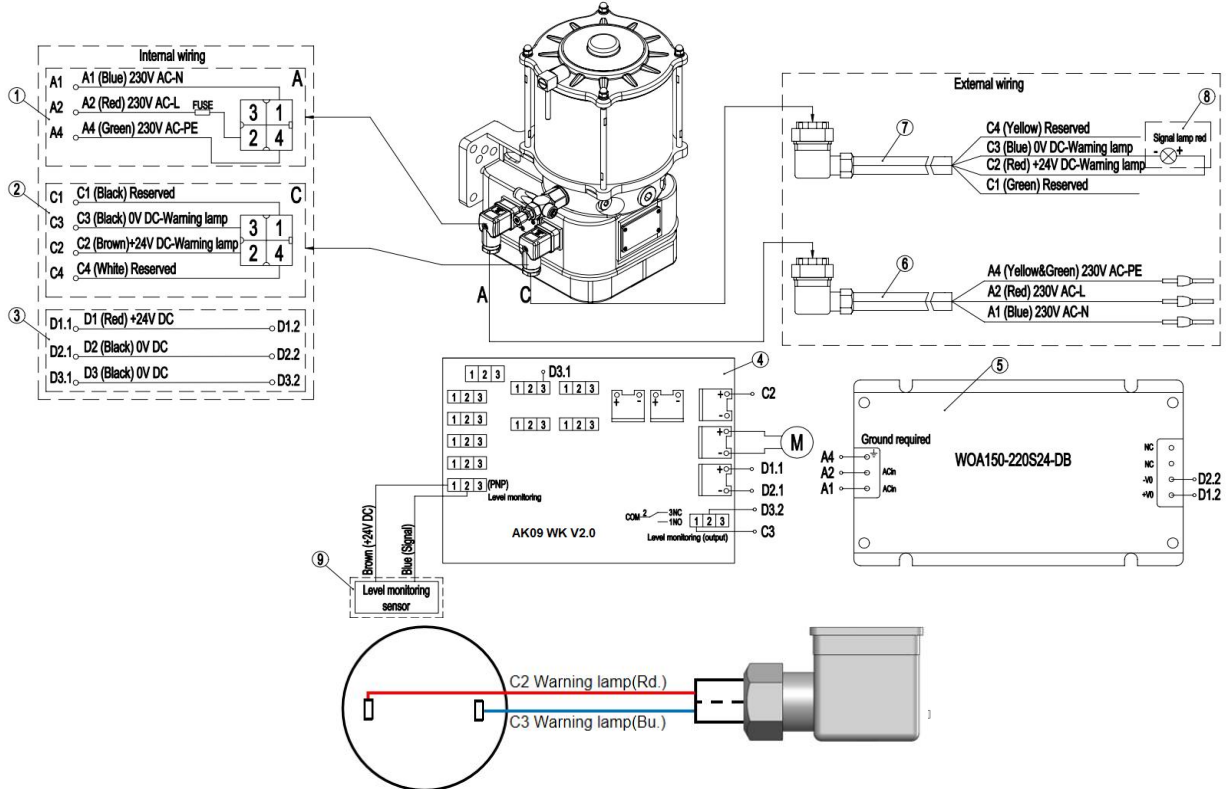

* In Dia. 31.1, it shows the pin connection for warning light with Part No. 3031000197. More details for the pin connection on test button and light please check the accessories catalogue.

Dia. 31.1 Wiring Diagram for ALPB HSC AC non-controller version

Pos.	Qty.	Description	Part No.
1	1	Wire kit-power supply-ALPB_HSC-230V AC-Int.-0,3m-HSC_M_4P-3xP_SNB1.25-4_F-3x1	2031001246
2	0-1	Wire kit-test button-ALPB_HSC-12/24V DC-Int.-0,3m-HSC_F-4P-2xP_JSTxH_F-2xP_JSTvH_F-4x0,5	2031000660
3	1	Wiring Set for Power Converter	2091000247
4A	1	Controller-AK09-WK-V2.0-12VDC-not programmable	2091000242
4B	1	Controller-AK09-WK-V2.0-24VDC-not programmable	2091000205
5	1	Pump Internal Power Converter Module 24V DC -230V AC	3030000153
6	1	Power Cable 7.5 meters - ALPB Hirschmann Connector 4 Pin-3*1-230V AC	2210000822
7	0-1	Test Button and Indication Light Cable 7.5 meters - ALPB (H) 4 Pin-4*0.5-24V DC	2210000351
8	0-1	Indication light-24VDC-red-M16	3031000197
9	1	Level monitoring sensor-ALPB for Stiring Paddle Type Pump	2031002091

* Instead of divider monitoring, the function for this wire kit in non-controller version pump is for grease level warning output.

AUTOL

Filling of the Pump

1. Only use EP-2 lubricating greases that are approved for the various operating temperatures.
2. Keep the pump being vertical during the filling process.
3. When refilling the pump, the marking for the maximum filling level must not be exceeded. Check the filling process and complete it in time before the maximum fill level indicator is reached.
4. It is strictly forbidden to remove the top cover of the pump for filling lubricants!
5. Only fill in clean lubricants! The service life of the pump elements highly depends on the quality of the used lubricants.

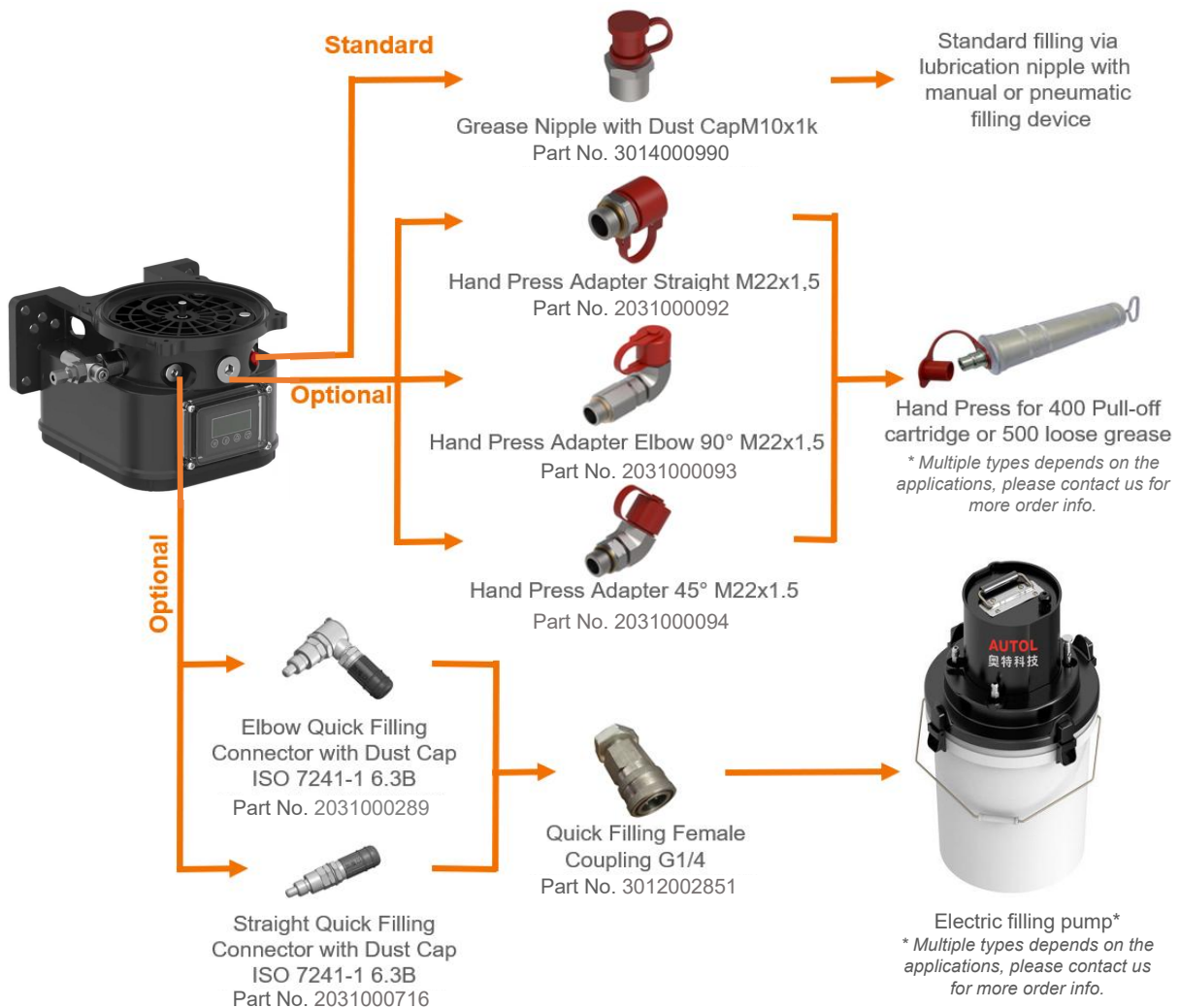

Dia. 32.1 Optional refilling devices for ALPB Pump

AUTOL

Explosion Drawing – ALPB Pump Body BYN + 2 - 4 Liter D170 Reservoir

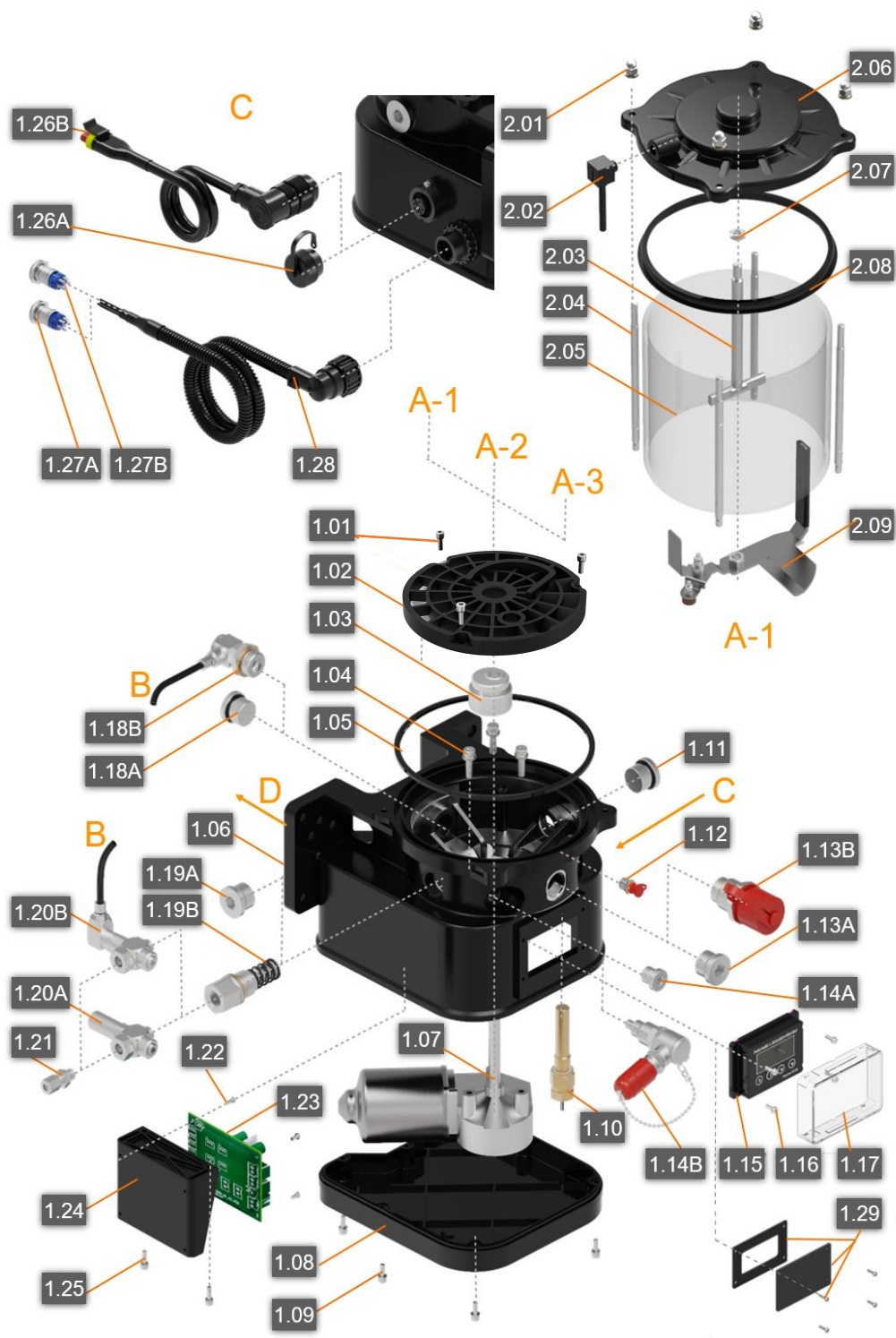

Explosion Drawing – ALPB Stirring Paddle Type and Spring Piston Type BYN(DC) Pump Body

Pos.	Qty.	Description	Part No.
1.01	3	Hexagon socket head cap screw-DIN_EN_ISO_4762-M4x12-8.8-ST-ZnNi-including flat- and spring washer	3014000338
1.02-1	1	Perforated base plate-ALPB-D142x18-PL	3021000299
1.02-2	1	Bearing D10-26-H8	3014000627
1.03-1	1	Eccentric Unit-EDS-D37	2031001570
1.03-2	1	Half-round pin-D13×3-H5	3012002792
1.03-3	1	Nylon ring gasket-D26-H12-PA6	3022000251
1.03-4	1	Rotating skeleton sealing-D16-16x10x4-TC	3024000127
1.04-1	3	Hexagon socket head cap screw-DIN_EN_ISO_4762-M6x25-A2-SS	3014000282
1.04-2	3	Flat washer with rubber sealing lip D6	3024000099
1.05	1	Sealing ring-grease reservoir bottom-ALPB-D170-170x160x3-NBR	3021000166
1.06	1	Pump body housing for lubrication pump-ALPB-BYN-AI-black painted	3012001749
1.07A	0-1	Direct current motor-12V/DC-CNLW	3030000089
1.07B	0-1	Direct current motor-24V/DC-CNLW	3030000091
1.08-1	1	Kit-pump body cover-ALPB-201x180x23,5-with sealing, screws and washers* (incl. 1.08-2 and 1.09)	3021000286
1.08-2	1	Sealing ring-pump body cover-ALPB-197x176×2.2 NBR	3021000288
1.09	8	Hexagon socket head cap screw-DIN_EN_ISO_4762-M4x20-A2-SS-including flat- and spring washer	3014000477
1.10	1	Min. level sensor-ALPB-12V-24V/DC-M14x1,5	2031002091
1.11	1	Screw plug-M22x1,5-(ED)-ST-ZnNi	3012003055
1.12	1	Grease nipple-M10x1-SS	3014000990
1.13A	0-1	Screw plug-M22x1,5-(ED)-ST-ZnNi	3012003055
1.13B	0-1	Filling connector-straight-M22x1,5-with dust cap-for Hand filling press	2031000092
1.14A	0-1	Screw plug-M14x1,5-(ED)-ST-ZnNi	3012000130
1.14B	0-1	Filling connector-swivel-ISO 7241-1B-M14x1,5-with dust cap	2031000289
1.15	0-1	LED-Display-AK06-(only display without controller)	2031000904
1.16	4	Cross recessed cheese head screw-M3x10-A2-SS-including flat- and spring washer	3014000421
1.17-1	0-1	LED-Display-AK06-transparent protective cover-100×68×15-PA	3021000376
1.17-2	0-1	Sealing ring-85×57×1.8 NBR	3021000377
1.17-3	0 or 4	Cross Slotted Pan Head Screw-M4x14-A2-70-including flat- and spring washer	3014001713
1.18A	0-1	Screw plug-M22x1,5-(ED)-ST-ZnNi	3012003055
1.18B	0-1	Kit-Single bypass for safety valve SV-A-M22x1,5	2031000878
1.19A	0-1	Screw plug-M22x1,5-(ED)-ST-ZnNi	3012003055
1.19B-A	0-1	Pump element-PE-1,5cm ³ /min-M22x1,5	2031001118
1.19B-B	0-1	Pump element-PE-2,5cm ³ /min-M22x1,5	2031001119
1.19B-C	0-1	Pump element-PE-4,5cm ³ /min-M22x1,5	2031001120
1.20A	0-1	Safety valve SV-C-preset to 300bar-G1/4-M10x1	2031001116
1.20B	0-1	Safety valve SV-A with indicator pin-preset to 300bar-G1/4-M10x1	2030000772
1.21	1	Straight screw coupling-GE-D6LL-M10x1 (SW14-ED)-ST-ZnNi	3012002826
1.22	4	Cross recessed cheese head screw-M3x6-A2-SS	3014000238
1.23A	0-1	Controller-AK09-V5.3-programmable (print board)-program code d-56 for Stirring Paddle Type Pump	2091000054
1.23B	0-1	Controller-AK09-V5.3-programmable (print board)-program code d-01 for Spring Piston Type Pump	2091000368
1.23C	0-1	Controller-AK09-WK-2.0-24VDC-not programmable	2091000205
1.23D	0-1	Controller-AK09-WK-2.0-12VDC-not programmable	2091000242
1.24	1	Fixing bracket (internal) for controller-AK09-95x72x33	3021000089
1.25	2	Hexagon socket head cap screw-DIN_EN_ISO_4762-M4x10-A2-SS-including flat- and spring washer	3014000348
1.26A-1	0-1	Wire kit-divider monitoring-12/24VDC-int.-0,3m-BD_F-4P-3xP_JSTxH_F-3x0,5	2031000104
1.26A-2	0-1	Protective cap divider monitoring at pump-BD-4 pin-IP67	3030000433
1.26B-A	0-1	Cable kit-divider monitoring-12/24VDC-Ext.-7,5m-BD_M_90_4P-APM_F_3P-3x0,5	2210000592
1.26B-B	0-1	Cable kit-divider monitoring-12/24VDC-Ext.-5,0m-BD_M_90_4P-APM_F_3P-3x0,5	2210000593

Explosion Drawing – ALPB BYN (DC) Pump Body

Pos.	Qty.	Description	Part No.
1.27A-A	0-1	Indication light-24VDC-red-M16	3031000197
1.27A-B	0-1	Indication light-12VDC-red-M16	3031000198
1.27B-A	0-1	Illuminated push button-24VDC-green_red_yellow-M16	3030000492
1.27B-B	0-1	Illuminated push button-12VDC-green_red_yellow-M16	3030000491
1.28-1A	0-1	Wire kit-power supply-ALPB_BYN-12VDC-Int.-0,3m-BYN_M_7P-4xP_JSTxH_F-3xP_JSTvH_F-7x0,5	2091000053
1.28-1B	0-1	Wire kit-power supply-ALPB_BYN-24VDC-Int.-0,3m-BYN_M_7P-4xP_JSTxH_F-3xP_JSTvH_F-7x0,5	2091000051
1.28-2A	0-1	Cable kit-power supply-12/24VDC-Ext.-7,5m-BYN-elbow connector-7 Pin-5x1,0	2210000634
1.28-2B	0-1	Cable kit-power supply-12/24VDC-Ext.-5,0m-BYN-elbow connector-7 Pin-5x1,0	2210000635
1.29-1	0-1	Blind plate-100×68×4-for without LED-Display-AK06	3011001807
1.29-2	0-1	Sealing ring-85×57×1.8 NBR	3021000377
1.29-3	0 or 4	Cross Slotted Pan Head Screw-M4x14-A2-70-including flat- and spring washer	3014001713

AUTOL

Explosion Drawing – ALPB HSC(DC and AC) Pump Body + 2 - 4 Liter D170 Stirring Paddle Type Reservoir

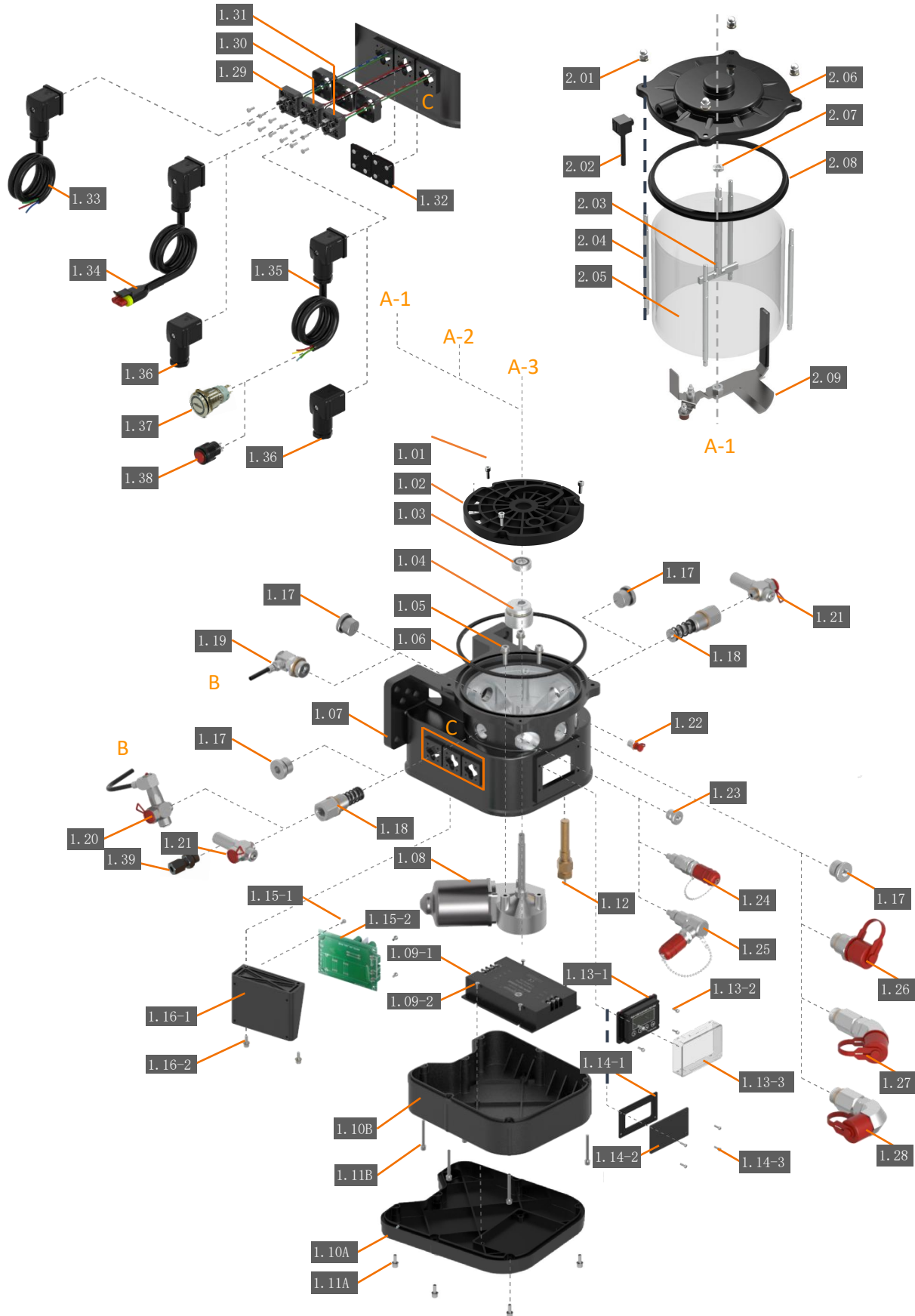

Explosion Drawing – ALPB Stirring Paddle Type and Spring Piston Type HSC(DC and AC) Pump Body

Pos.	Qty.	Description	Part No.
1.01	3	Hexagon socket head cap screw-DIN_EN_ISO_4762-M4x12-8.8-ST-ZnNi-including flat- and spring washer	3014000338
1.02	1	Perforated base plate-ALPB-D142x18-PL	3021000299
1.03	1	Bearing D10-26-H8	3014000627
1.04-1	1	Eccentric Unit-EDS-D37	2031001570
1.04-2	1	Half-round pin-D13×3-H5	3012002792
1.04-3	1	Nylon ring gasket-D26-H12-PA6	3022000251
1.04-4	1	Rotating skeleton sealing-D16-16x10x4-TC	3024000127
1.05-1	3	Hexagon socket head cap screw-DIN_EN_ISO_4762-M6x25-A2-SS	3014000282
1.05-2	3	Flat washer with rubber sealing lip D6	3024000099
1.06	1	Sealing ring-grease reservoir bottom-ALPB-D170-170x160x3-NBR	3021000166
1.07	1	Pump body housing for lubrication pump-ALPB-HSC-AI-black painted	3012004696
1.08A	0-1	Direct current motor-12V/DC-CNLW	3030000089
1.08B	0-1	Direct current motor-24V/DC-CNLW	3030000091
1.09-1	1	Power Converter Module (230V AC to 24V DC)-For ALPB 230V AC HSC Pump* (incl. 1.09-2)	3030000153
1.09-2	4	Cross-recessed pan head self-tapping screw-ST2.9x9.5-A2	3014000317
1.10A-1	1	Kit-pump body cover-ALPB-200x179x23,5-with sealing, screws and washers* (Use with 1.10A-2 and 1.11A)	3021000286
1.10A-2	1	Sealing ring-pump body cover-ALPB-197x176×2.2 NBR	3021000288
1.11A	8	Hexagon socket head cap screw-DIN_EN_ISO_4762-M4x20-A2-SS-including flat- and spring washer	3014000477
1.10B	1	Kit-pump body cover-ALPB-201x180x53,5-with sealing, screws and washers* (Use with 1.10A-2 and 1.11B)	3021000305
1.11B	8	Hexagon socket head cap screw-DIN_EN_ISO_4762-M4x40-A2-SS-including flat- and spring washer	3014000503
1.12	1	Min. level sensor-ALPB-12V-24V/DC-M14x1,5	2031002091
1.13-1	0-1	LED-Display-AK06-(only display without controller)	2031000904
1.13-2	4	Cross recessed cheese head screw-M3x10-A2-SS-including flat- and spring washer	3014000421
1.13-3-1	0-1	LED-Display-AK06-transparent protective cover-100×68×15-PA	3021000376
1.13-3-2	0-1	Sealing ring-85×57×1.8 NBR	3021000377
1.13-3-3	0 or 4	Cross Slotted Pan Head Screw-M4x14-A2-70-including flat- and spring washer	3014001713
1.14-1	0-1	Blind plate-100×68×4-for without LED-Display-AK06	3011001807
1.14-2	0-1	Sealing ring-85×57×1.8 NBR	3021000377
1.14-3	0 or 4	Cross Slotted Pan Head Screw-M4x14-A2-70-including flat- and spring washer	3014001713
1.15-1	4	Cross recessed cheese head screw-M3x6-A2-SS	3014000238
1.15-2A	0-1	Controller-AK09-V5.3-programmable (print board)-program code d-56 for Stirring Paddle Type Pump	2091000054
1.15-2B	0-1	Controller-AK09-V5.3-programmable (print board)-program code d-01 for Spring Piston Type Pump	2091000368
1.15-2C	0-1	Controller-AK09-WK-2.0-24VDC-not programmable	2091000205
1.15-2D	0-1	Controller-AK09-WK-2.0-12VDC-not programmable	2091000242
1.16-1	1	Fixing bracket (internal) for controller-AK09-95x72x33	3021000089
1.16-2	2	Hexagon socket head cap screw-DIN_EN_ISO_4762-M4x10-A2-SS-including flat- and spring washer	3014000348
1.17	0-1	Screw plug-M22x1,5-(ED)-ST-ZnNi	3012003055
1.18A	0-1	Pump element-PE-1,5cm3/min-M22x1,5	2031001118
1.18B	0-1	Pump element-PE-2,5cm3/min-M22x1,5	2031001119
1.18C	0-1	Pump element-PE-4,5cm3/min-M22x1,5	2031001120
1.19	0-1	Kit-Single bypass for safety valve SV-A-M22x1,5	2031000878
1.20A	0-1	Safety valve SV-A-preset to 300bar-G1/4-M10x1	2031000747
1.20B	0-1	Safety valve SV-A with indicator pin-preset to 300bar-G1/4-M10x1	2030000772
1.21	0-1	Safety valve SV-C-preset to 300bar-G1/4-M10x1	2031001116
1.22	1	Grease nipple-M10x1-SS	3014000990
1.23	0-1	Screw plug-M14x1,5-(ED)-ST-ZnNi	3012000130
1.24	0-1	Quick Filling connector-Straight-ISO 7241-1B-M14x1,5-with dust cap	2031000716
1.25	0-1	Quick Filling connector-Elbow-ISO 7241-1B-M14x1,5-with dust cap	2031000289
1.26	0-1	Hand Press Adapter-straight-M22x1,5-with dust cap-for Hand filling press	2031000092
1.27	0-1	Hand Press Adapter-45°-M22x1,5-with dust cap-for Hand filling press	2031000094
1.28	0-1	Hand Press Adapter Elbow-M22x1,5-with dust cap-for Hand filling press	2031000093
1.39	1	Straight screw coupling-GE-D6LL-M10x1 (SW14-ED)-ST-ZnNi	3012002826

Explosion Drawing – ALPB Stirring Paddle Type HSC (DC and AC) Pump Body

Pos.	Qty.	Description	Part No.
1.29-1A	0-1	Wire kit-power supply-ALPB_HSC-12V DC-Int.-0,3m-HSC_M_4P-3xP_SNBM1.25-4_F-3x1	2031000529
1.29-1B	0-1	Wire kit-power supply-ALPB_HSC-24V DC-Int.-0,3m-HSC_M_4P-3xP_SNBM1.25-4_F-3x1	2031000525
1.29-1C	0-1	Wire kit-power supply-ALPB_HSC-230V AC-Int.-0,3m-HSC_M_4P-3xP_SNBM1.25-4_F-3x1	2031001246
1.29-2	4	Cylinder Screw with Cross Groove M3 L10-A2	3014000236
1.29-3	1	Connector gasket	3020000239
1.30-1	0-1	Wire kit-divider monitoring-ALPB_HSC-12/24V DC-Int.-0,3m-HSC_F-4P-3xP_JSTxH_F-3x0,5	2031000521
1.30-2	0 or 4	Cylinder Screw with Cross Groove M3 L10-A2	3014000236
1.30-3	0-1	Connector gasket	3020000239
1.31-1	0-1	Wire kit-test button-ALPB_HSC-12/24V DC-Int.-0,3m-HSC_F-4P-2xP_JSTxH_F-2xP_JSTvH_F-4x0,5	2031000660
1.31-2	0 or 4	Cylinder Screw with Cross Groove M3 L10-A2	3014000236
1.31-3	0-1	Connector gasket	3020000239
1.32	0-2	Blind Plate Set with Sealing Plate and Screws for ALPB Hirschmann Connector* (incl. 1.32-1, 1.32-2 and 1.32-3)	2030000627
1.32-1	1	Blind Plate Set	3030000419
1.32-2	1	Sealing Plate	3014000493
1.32-3	4	Cylinder Screw with Cross Groove M3 L8-A2	3014000493
1.33A	1	Power Cable 7.5 meters - ALPB Hirschmann Connector 4 Pin-2*1-12/24V DC	2210000203
1.33B	1	Power Cable 7.5 meters - ALPB Hirschmann Connector 4 Pin-3*1-230V AC	2210000822
1.34	0-1	Divider Monitoring Signal Input Cable 7.5 meters - ALPB (H) 4 Pin - AMP 3 Pin-4P-APM_F_3P-3x0,5	2210000303
1.35	0-1	Test Button and Indication Light Cable 7.5 meters - ALPB (H) 4 Pin-4*0.5-24V DC	2210000351
1.36	0-2	Blind Plug for ALPB Hirschmann Socket	2031001146
1.37A	0-1	Illuminated push button-24VDC-green_red_yellow-M16	3030000492
1.37B	0-1	Illuminated push button-12VDC-green_red_yellow-M16	3030000491
1.38A	0-1	Indication light-24VDC-red-M16	3031000197
1.38B	0-1	Indication light-12VDC-red-M16	3031000198

AUTOL

Explosion Drawing: 8 – 20 Liter D230 Reservoir ALPB Stirring Paddle Type Pump

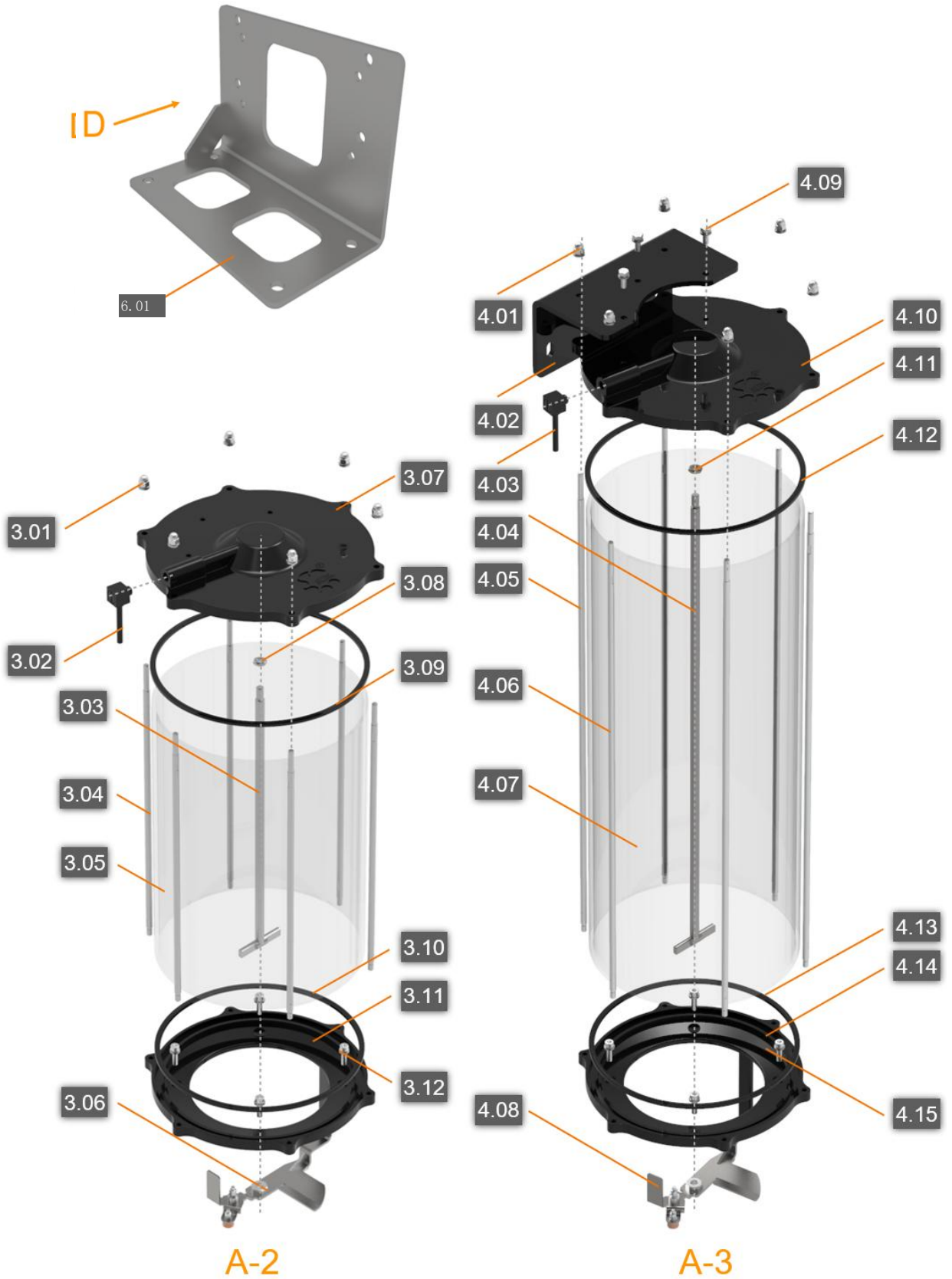

General BOM - ALPB Stirring Paddle Type Pump Reservoir Kit - 1 (2 - 20 L)

Pos.	Qty.	Description	Part No.
2.00A	0-1	Kit-grease reservoir attached to pump body-ALPB-D170-2L-(full package) * (incl. 2.01-2.09)	/
2.00B	0-1	Kit-grease reservoir attached to pump body-ALPB-D170-4L-(full package) * (incl. 2.01-2.09)	/
2.01-1	4	Hexagon acorn nut-DIN_1587-M6-6_A2-SS	3014000292
2.01-2	4	Flat washer-6,5x11,7x1,5-(M6)-A2-SS	3014000191
2.01-3	4	Spring washer-6,3x9,5x1,75-(M6)-A2-SS	3014000192
2.02	1	Kit ventilation-grease reservoir-ALPB	2031001165
2.03A	0-1	T-rod for grease distribution at reservoir-ALPB-D170-2L-D10-L124-ST-ZnNi	3012002437
2.03B	0-1	T-rod for grease distribution at reservoir-ALPB-D170-4L-D10-L274.5-ST-ZnNi	3012002410
2.04A	0 or 4	Tie-rod for grease reservoir-ALPB-D170-2L-D7-M6-L161-ST-ZnNi	3012002660
2.04B	0 or 4	Tie-rod for grease reservoir-ALPB-D170-4L-D7-M6-L306-ST-ZnNi	3012002685
2.05A	0-1	Grease reservoir-transparent-ALPB-D170-2L-L140	3022000210
2.05B	0-1	Grease reservoir-transparent-ALPB-D170-4L-L285	3022000238
2.06	1	Top cover-ALPB-D170-ST-black painted	3012002678
2.07	1	Low hexagon nut-DIN_EN_ISO_4035-M8-A2-SS	3014000316
2.08	1	Z-sealing ring-grease reservoir top-ALPB-D170-160x176,6x10-NBR	3021000199
2.09	1	Kit-agitator blade with stirring paddle, magnet and guide plate-ALPB-D170	2031000522
3.00A	0-1	Kit-grease reservoir attached to pump body-ALPB-D230-4L-(full package) * (incl. 3.01-3.12)	/
3.00B	0-1	Kit-grease reservoir attached to pump body-ALPB-D230-8L-(full package) * (incl. 3.01-3.12)	/
3.01-1	6	Hexagon acorn nut-DIN_1587-M6-6_A2-SS	3014000292
3.01-2	6	Flat washer-6,5x11,7x1,5-(M6)-A2-SS	3014000191
3.01-3	6	Spring washer-6,3x9,5x1,75-(M6)-A2-SS	3014000192
3.02	1	Kit ventilation-grease reservoir-ALPB	2031001165
3.03A	0-1	T-rod for grease distribution at reservoir-ALPB-D230-4L-D10-L162-ST-ZnNi	3012002421
3.03B	0-1	T-rod for grease distribution at reservoir-ALPB-D230-8L-D10-L334-ST-ZnNi	3012002407
3.04A	0 or 6	Tie-rod for grease reservoir-ALPB-D170-4L-D7-M6-L176-ST-ZnNi	3012004214
3.04B	0 or 6	Tie-rod for grease reservoir-ALPB-D170-8L-D7-M6-L348-ST-ZnNi	3012002680
3.05A	0-1	Grease reservoir-transparent-ALPB-D230-4L-L150	3022000085
3.05B	0-1	Grease reservoir-transparent-ALPB-D230-8L-L322	3022000261
3.06	1	Kit-agitator Blade with stirring paddle, magnet and guide plate-ALPB-D230	2031000901
3.07	1	Top cover-ALPB-D230-Al-black painted	3012001836
3.08	1	Low hexagon nut-DIN_EN_ISO_4035-M8-A2-SS	3014000316
3.09	1	Sealing ring-grease reservoir-ALPB-D230-232x220x3-NBR	3021000170
3.10	1	Sealing ring-grease reservoir-ALPB-D230-232x220x3-NBR	3021000170
3.11	1	Intermediate flange for grease reservoir-ALPB-D170-D230-240x22-Al-black painted	3012001305
3.12-1	4	Hexagon socket head cap screw-DIN_EN_ISO_4762-M6x20-A2-SS	3014000280
3.12-2	4	Flat washer with rubber sealing lip D6	3024000099
4.00A	0-1	Kit-grease reservoir attached to pump body-ALPB-D230-15L-(full package) *(incl. 4.01-4.15)	/
4.00B	0-1	Kit-grease reservoir attached to pump body-ALPB-D230-20L-(full package) *(incl. 4.01-4.15)	/
4.01-1	6	Hexagon acorn nut-DIN_1587-M6-6-A2-SS	3014000292
4.01-2	6	Flat washer-6,5x11,7x1,5-(M6)-A2-SS	3014000191
4.01-3	6	Spring washer-6,3x9,5x1,75-(M6)-A2-SS	3014000192
4.02	1	Mounting bracket-grease reservoir top cover-ALPB-D230-Al-black painted	3011000906

General BOM - ALPB Stirring Paddle Type Pump Reservoir Kit - 2 (2 - 20 L)

Pos.	Qty.	Description	Part No.
4.03	1	Kit ventilation-grease reservoir-ALPB	2031001165
4.04A	0-1	T-rod for grease distribution at reservoir-ALPB-D230-15L-D10-L417-ST-ZnNi	3012000386
4.04B	0-1	T-rod for grease distribution at reservoir-ALPB-D230-20L-D10-L560-ST-ZnNi	3012000387
4.05A	0 or 4	Tie-rod for grease reservoir-ALPB-D230-15L-D7-M6-L452-ST-ZnNi-for with top cover bracket	3012002696
4.05B	0 or 4	Tie-rod for grease reservoir-ALPB-D230-20L-D7-M6-L601-ST-ZnNi-for with top cover bracket	3012002675
4.06A	0 or 2	Tie-rod for grease reservoir-ALPB-D230-15L-D7-M6-L458-ST-ZnNi-for without top cover bracket	3012002697
4.06B	0 or 2	Tie-rod for grease reservoir-ALPB-D230-20L-D7-M6-L595-ST-ZnNi-for without top cover bracket	3012002676
4.07A	0-1	Grease reservoir-transparent-ALPB-D230-15L-L427	3022000283
4.07B	0-1	Grease reservoir-transparent-ALPB-D230-20L-L570	3022000284
4.08	1	Kit-agitator Blade with stirring paddle, magnet and guide plate-ALPB-D230	2031000901
4.09-1	3	Hexagon head bolt-ISO_4017-M6x15-A2-SS	3014000277
4.09-2	3	Flat washer-6,5x11,7x1,5-(M6)-A2-SS	3014000191
4.09-3	3	Spring washer-6,3x9,5x1,75-(M6)-A2-SS	3014000192
4.10	1	Top cover-ALPB-D230-Al-black painted	3012001371
4.11	1	Low hexagon nut-DIN_EN_ISO_4035-M8-A2-SS	3014000316
4.12	1	Sealing ring-grease reservoir-ALPB-D230-232x220x3-NBR	3021000170
4.13	1	Sealing ring-grease reservoir-ALPB-D230-232x220x3-NBR	3021000170
4.14	1	Intermediate flange for grease reservoir-ALPB-D170-D230-240x22-Al-black painted	3012001305
4.15-1	4	Hexagon socket head cap screw-DIN_EN_ISO_4762-M6x20-8.8-ST-ZnNi	3014000280
4.15-2	4	Flat washer with rubber sealing lip D6	3024000099
6.01	1	Mounting bracket-lubrication pump-ALPB-with welded counter nut-275x150x190-ST-black painted	3011001170

AUTOL

Explosion Drawing: 4 - 15 Liter D230 Reservoir ALPB Spring Piston Type Pump

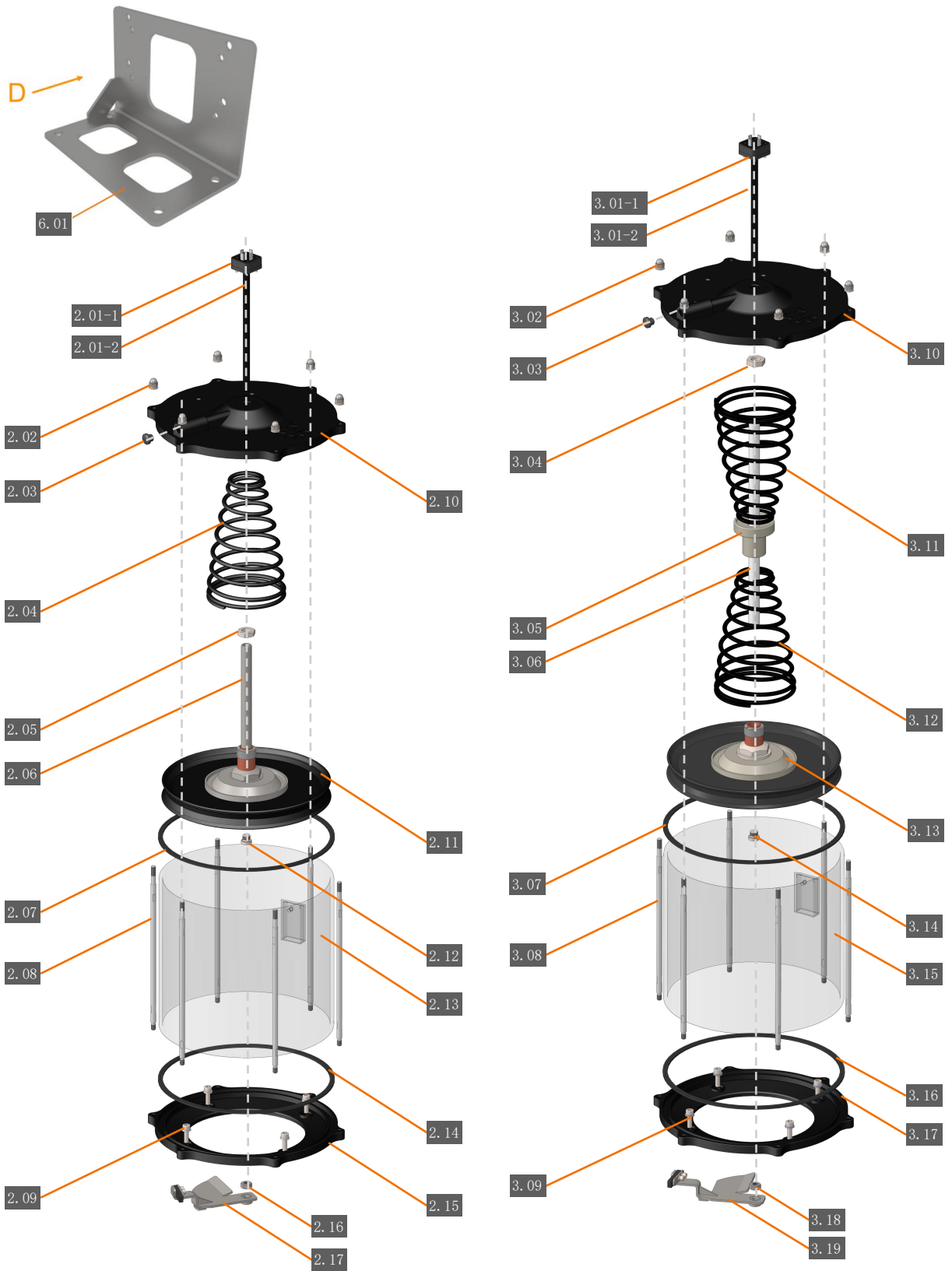

TD - Explo. DWG

ALPB PROGRESSIVE PUMP

AUTOL

Explosion Drawing: 4 - 15 Liter D230 Reservoir ALPB Spring Piston Type Pump

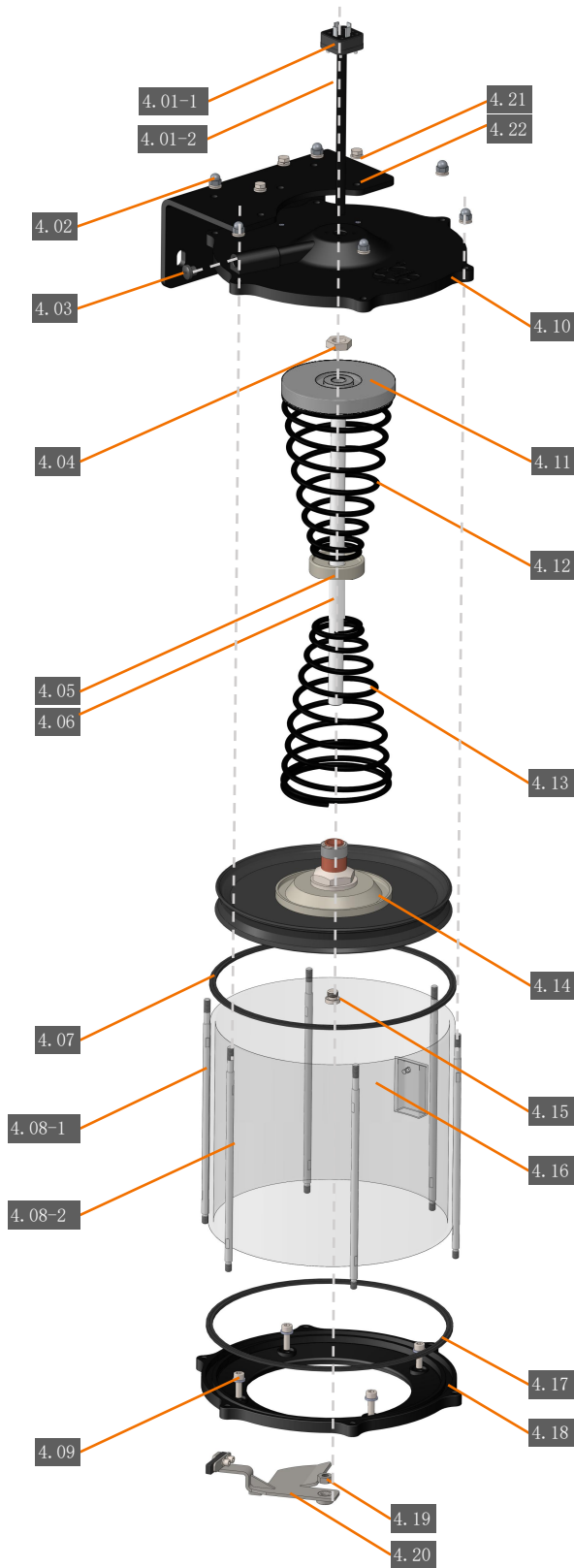

AUTOL

Explosion Drawing: 20 – 30 Liter D314 Reservoir ALPB Spring Piston Type Pump

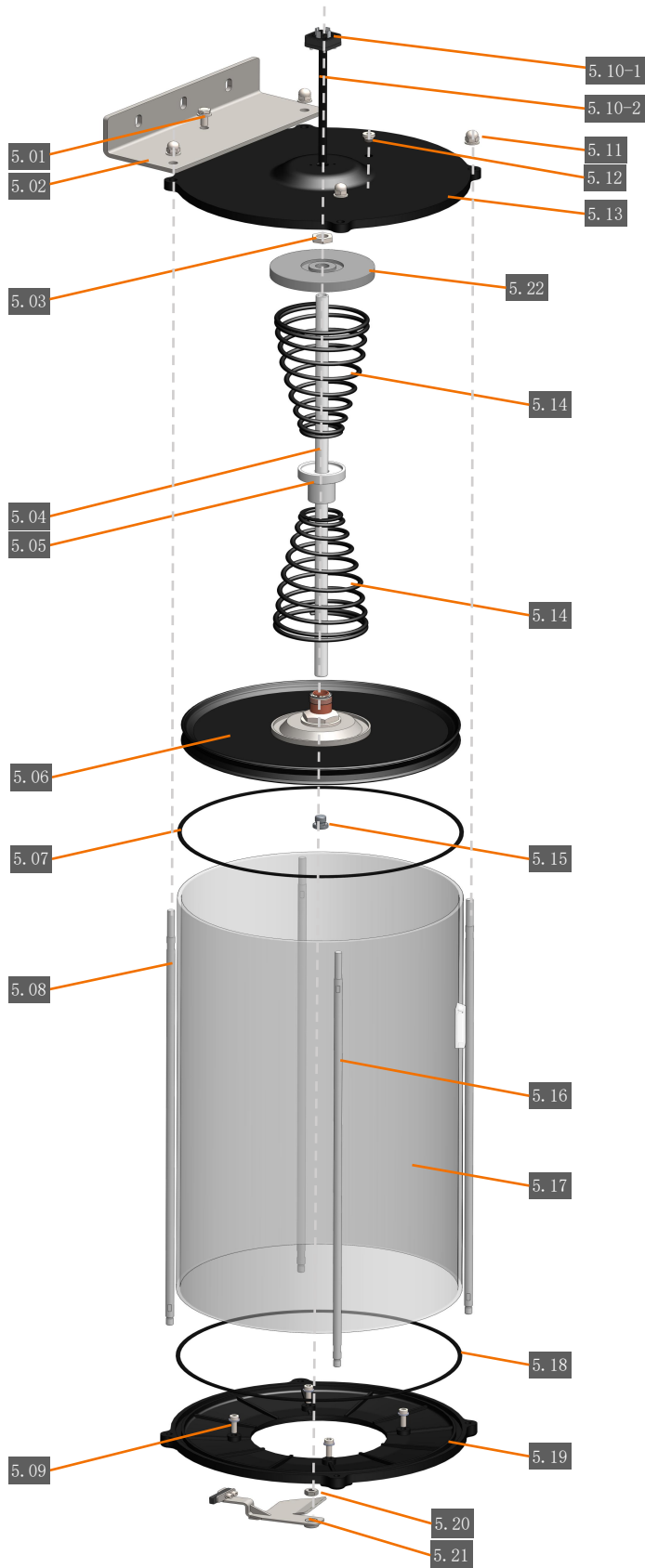

General BOM - ALPB Spring Piston Pump Reservoir Kit - 1 (4 and 8 L)

Pos.	Qty.	Description	Part No.
2.00	0-1	Kit-grease reservoir attached to pump body-ALPB-D230-4L-(full package) * (incl. 2.01-2.17)	/
2.01-1	1	Min. level sensor-ALPB Spring Piston Pump	2031001285
2.01-2	1	Sensor retaining sleeve-4L-D9-7×200	3020000262
2.02-1	6	Hexagon acorn nut-DIN_1587-M6-6_A2-SS	3014000292
2.02-2	6	Flat washer-6,5x11,7x1,5-(M6)-A2-SS	3014000191
2.02-3	6	Spring washer-6,3x9,5x1,75-(M6)-A2-SS	3014000192
2.03	1	Dust-proof screw plug(M10)-PA	3022000230
2.04	1	Tapered spring-D104-46×288×5.5-55CrSi	3013000070
2.05	1	Hexagon thin nut-M14×1-A2-SS	3014000360
2.06	1	Piston guide rod-D14×206-4L-A2-SS	3012002425
2.07	1	Sealing ring-grease reservoir-ALPB-D230-232x220x3-NBR	3021000170
2.08	6	Tie-rod for grease reservoir-ALPB-D230-4L-D7-M6-L176-ST-ZnNi	3012004214
2.09-1	4	Hexagon socket head cap screw-DIN_EN_ISO_4762-M6x20-A2-SS	3014000280
2.09-2	4	Flat washer with rubber sealing lip D6	3024000099
2.10	1	Top cover-ALPB-D230-AI-black painted	3012001836
2.11	1	Double-sealed piston kit-ALPB D224 NBR	2031001878
2.12	1	Screw plug-M12x1,5-(ED)-ST-Cr	3012002849
2.13	1	Grease reservoir-transparent-ALPB-D230-220-4L-L217-PC	3022000259
2.14	1	Sealing ring-grease reservoir-ALPB-D230-232x220x3-NBR	3021000170
2.15	1	Intermediate flange for grease reservoir-ALPB-D170-D230-240x22-AI-black painted	3012001305
2.16	1	Hexagon nut-M8×1-A2-SS	3014000494
2.17	1	Kit-agitator Blade with stirring paddle, magnet and guide plate-ALPB-D230	2031000901
3.00	0-1	Kit-grease reservoir attached to pump body-ALPB-D230-8L-(full package) * (incl. 3.01-3.19)	/
3.01-1	1	Min. level sensor-ALPB Spring Piston Pump	2031001279
3.01-2	1	Sensor retaining sleeve-8L-D9-7×305	3020000263
3.02-1	6	Hexagon acorn nut-DIN_1587-M6-6_A2-SS	3014000292
3.02-2	6	Flat washer-6,5x11,7x1,5-(M6)-A2-SS	3014000191
3.02-3	6	Spring washer-6,3x9,5x1,75-(M6)-A2-SS	3014000192
3.03	1	Dust-proof screw plug(M10)-PA	3022000230
3.04	1	Hexagon thin nut-M14×1-A2-SS	3014000360
3.05	1	Guide pillars for tapered spring-D52-L49	3012001801
3.06	1	Piston guide rod-D14×311-8L-A2-SS	3012002426
3.07	1	Sealing ring-grease reservoir-ALPB-D230-232x220x3-NBR	3021000170
3.08	6	Tie-rod for grease reservoir-ALPB-D230-8L-D7-M6-L348-ST-ZnNi	3012002680
3.09-1	4	Hexagon socket head cap screw-DIN_EN_ISO_4762-M6x20-A2-SS	3014000280
3.09-2	4	Flat washer with rubber sealing lip D6	3024000099
3.10	1	Top cover-ALPB-D230-AI-black painted	3012001836
3.11	1	Tapered spring-D104-46×288×5.5-55CrSi	3013000070
3.12	1	Tapered spring-D104-46×288×5.5-55CrSi	3013000070
3.13	1	Double-sealed piston kit-ALPB D224 NBR	2031001878
3.14	1	Screw plug-M12x1,5-(ED)-ST-Cr	3012002849
3.15	1	Grease reservoir-transparent-ALPB-D230-220-8L-L322-PC	3022000260
3.16	1	Sealing ring-grease reservoir-ALPB-D230-232x220x3-NBR	3021000170
3.17	1	Intermediate flange for grease reservoir-ALPB-D170-D230-240x22-AI-black painted	3012001305
3.18	1	Hexagon nut-M8×1-A2-SS	3014000494
3.19	1	Kit-agitator Blade with stirring paddle, magnet and guide plate-ALPB-D230	2031000901

General BOM - ALPB Spring Piston Pump Reservoir Kit - 2 (15 L)

Pos.	Qty.	Description	Part No.
4.00	0-1	Kit-grease reservoir attached to pump body-ALPB-D230-15L-(full package) * (incl. 4.01-4.22)	/
4.01-1-1	1	Min. level sensor-ALPB Spring Piston Pump-15L	2031000881
4.01-1-2	1	Connector sheath-18×18	3020000239
4.01-1-3	1	Connector gasket-31.9×31.9×15-NBR	3021000301
4.01-2	1	Sensor retaining sleeve-8L-D9-7×553	3020000259
4.02-1	6	Hexagon acorn nut-DIN_1587-M6-6_A2-SS	3014000292
4.02-2	6	Flat washer-6,5x11,7x1,5-(M6)-A2-SS	3014000191
4.02-3	6	Spring washer-6,3x9,5x1,75-(M6)-A2-SS	3014000192
4.03	1	Dust-proof screw plug(M10)-PA	3022000230
4.04	1	Hexagon thin nut-M14×1-A2-SS	3014000360
4.05	1	Guide pillars for tapered spring-D00-L20-PA66	3022000290
4.06	1	Piston guide rod-D14×559-15L-A2-SS	3012002428
4.07	1	Sealing ring-grease reservoir-ALPB-D230-232x220x3-NBR	3021000170
4.08-1	2	Tie-rod for grease reservoir-ALPB-D230-15L-D7-M6-L601-ST-ZnNi	3012002676
4.08-2	4	Tie-rod for grease reservoir-ALPB-D230-15L-D7-M6-L595-ST-ZnNi	3012002675
4.09-1	4	Hexagon socket head cap screw-DIN_EN_ISO_4762-M6x20-A2-SS	3014000280
4.09-2	4	Flat washer with rubber sealing lip D6	3024000099
4.10	1	Top cover-ALPB-D230-Al-black painted	3012001368
4.11	1	Tapered spring positioning seat-D125×14-PA66	3022000289
4.12	1	Tapered spring-D110-84×316×7-55CrSi	3013000072
4.13	1	Tapered spring-D110-84×316×7-55CrSi	3013000072
4.14	1	Double-sealed piston kit-ALPB D224 NBR	2031001879
4.15	1	Screw plug-M12x1,5-(ED)-ST-Cr	3012002849
4.16	0-1	Grease reservoir-transparent-ALPB-D230-220-15L-L570-PC	3022000279
4.17	1	Sealing ring-grease reservoir-ALPB-D230-232x220x3-NBR	3021000170
4.18	1	Intermediate flange for grease reservoir-ALPB-D170-D230-240x22-Al-black painted	3012001305
4.19	1	Hexagon nut-M8×1-A2-SS	3014000494
4.20	1	Kit-agitator Blade with stirring paddle, magnet and guide plate-ALPB-D230	2031000901
4.21-1	3	Hexagon head bolt-ISO_4017-M6x15-A2-SS	3014000277
4.21-2	3	Flat washer-6,5x11,7x1,5-(M6)-A2-SS	3014000191
4.21-3	3	Spring washer-6,3x9,5x1,75-(M6)-A2-SS	3014000192
4.22	1	Mounting bracket-grease reservoir top cover-ALPB-D230-Al-black painted	3011000906
6.01	1	Mounting bracket-lubrication pump-ALPB-with welded counter nut-275x150x190-ST-black painted	3011001170

General BOM - ALPB Spring Piston Pump Reservoir Kit - 3 (20 and 30 L)

Pos.	Qty.	Description	Part No.
5.00A	0-1	Kit-grease reservoir attached to pump body-ALPB-D314-20L-(full package) * (incl. 5.01-5.21)	/
5.00B	0-1	Kit-grease reservoir attached to pump body-ALPB-D314-30L-(full package) * (incl. 5.01-5.22)	/
5.01-1	1	Hexagon head bolt (perforated)-M8_A2-SS	3012002785
5.01-2	1	Flat washer-8-A2-SS	3014000200
5.01-3	1	Spring washer-8-(M8)-A2-SS	3014000201
5.02	1	Mounting bracket-grease reservoir top cover-ALPB-D314 Reservoir-AI-black painted	3011001203
5.03	1	Hexagon thin nut-M14×1-A2-SS	3014000360
5.04A	0-1	Piston guide rod-D14×410-20L-A2-SS	3012001810
5.04B	0-1	Piston guide rod-D14×583-30L-A2-SS	3012002423
5.05	1	Guide pillars for tapered spring-D52-L49-PA66	3012001801
5.06	1	Double-sealed piston kit-ALPB D314 NBR	2031001880
5.07	1	Sealing ring-grease reservoir-ALPB-D314-315x302x3-NBR	3021000198
5.08-1A	0-2	Tie-rod for grease reservoir-ALPB-D314-20L-D9-M8-L484-ST-ZnNi	3012002434
5.08-1B	0-2	Tie-rod for grease reservoir-ALPB-D314-30L-D9-M8-L641-ST-ZnNi	3012001111
5.09-1	4	Hexagon socket head cap screw-DIN_EN_ISO_4762-M6x20-A2-SS	3014000280
5.09-2	4	Flat washer with rubber sealing lip D6	3024000099
5.10-1-1A	0-1	Min. level sensor-ALPB Spring Piston Pump-20L	2031000881
5.10-1-1B	0-1	Min. level sensor-ALPB Spring Piston Pump-30L	2031001864
5.10-1-2	1	Connector sheath-18×18	3020000239
5.10-1-3	1	Connector gasket-31.9×31.9×15-NBR	3021000301
5.10-2A	0-1	Sensor retaining sleeve-20L-D9-7×398	3020000339
5.10-2B	0-1	Sensor retaining sleeve-30L-D9-7×577	3020000261
5.11-1	4	Hexagon acorn nut-DIN_1587-M8_A2-SS	3014000313
5.11-2	4	Flat washer-8-(M8)-A2-SS	3014000200
5.11-3	4	Spring washer-8-(M8)-A2-SS	3014000201
5.12	1	Screw plug-M10x1-(ED)-ST-ZnNi	3012003079
5.13	1	Top cover-ALPB-D314-AI-black painted	3012001804
5.14A	0 or 2	Tapered spring-D104-46×288×5.5-55CrSi-20L	3013000070
5.14B	0 or 3	Tapered spring-D104-46×288×5.5-55CrSi-30L	3013000070
5.15	1	Screw plug-M12x1,5-(ED)-ST-Cr	3012002849
5.16A	0-2	Tie-rod for grease reservoir-ALPB-D314-20L-D9-M8-L478-ST-ZnNi	3012002433
5.16B	0-2	Tie-rod for grease reservoir-ALPB-D314-30L-D9-M8-L635-ST-ZnNi	3012002700
5.17A	0-1	Grease reservoir-transparent-ALPB-D314-305-20L-L444-PC	3022000296
5.17B	0-1	Grease reservoir-transparent-ALPB-D314-305-30L-L600-PC	3022000280
5.18	1	Sealing ring-grease reservoir-ALPB-D314-315x302x3-NBR	3021000198
5.19	1	Intermediate flange for grease reservoir-ALPB-D170-D314-330x23-AI-black painted	3011001396
5.20	1	Hexagon nut-M8×1-A2-SS	3014000494
5.21	1	Kit-agitator Blade with stirring paddle, magnet and guide plate-ALPB-D314	/
5.22	0-1	Tapered spring positioning seat-D115×15-PA66	3022000288

Delivery, returns and storage

Delivery

After receipt of the shipment, check the shipment for damage and completeness according to the shipping documents. Immediately report any transport damages to the forwarding agent. Keep the packaging material until any discrepancies are resolved. During in-house transport ensure safe handling.

Returns

Clean all parts and pack them properly (i.e., following the regulations of the recipient country) before returning them. Protect the product against mechanical influences such as impacts. There are no restrictions for land, sea or air transport.

Storage

Autol Technology products are subject to the following storage conditions:

- dry, dust- and vibration-free in closed premises
- no corrosive, aggressive materials at the place of storage (e. g. UV rays, ozone)
- protected against pests and animals (insects, rodents, etc.)
- possibly in the original product packaging
- shielded from nearby sources of heat and coldness
- in case of high temperature fluctuations or high humidity take adequate measures (e. g. heater) to prevent the formation of condensation water

Storage conditions for parts filled with lubricant

The conditions mentioned in the following will have to be adhered to when storing products filled with lubricant.

Storage period of up to 6 months

The filled products can be used without having to take further measures.

Step for Storage period from 6 to 18 months - Pump



1. Connect the pump electrically
2. Switch the pump on and let it run, e.g., by triggering an additional lubrication, until about 4 cc of lubricant will leak from each pump element
3. Switch the pump off and disconnect it from the electrical grid
4. Remove and dispose of leaked lubricant

Step for Storage period from 6 to 18 months - Divider



1. Remove all connection lines and closure screws
2. Connect the pump which has been filled with new lubrication grease suitable for the application purpose to the divider
3. Let the pump run until new lubricant leaks from the divider
4. Remove leaked lubricant
5. Reinstall closure screws and connection lines

AUTOL

Step for Storage period from 6 to 18 months - Hose

1. Dismantle preassembled hose
2. Ensure that both sides of the hose remain open
3. Fill hose with new lubricant

Storage period exceeding 18 months

To avoid dysfunctions, consult the manufacturer before commissioning. The general procedure to remove the old grease filling corresponds to that of a storage period from 6 to 18 months

Installation

General information

Only qualified technical personnel may install the products described in these Instructions. During assembly pay attention to the following:

- Other units must not be damaged by the assembly
- The product must not be installed within the range of moving parts
- The product must be installed at an adequate distance from sources of heat and coldness
- Observe the product's IP degree of protection
- Adhere to safety distances and legal prescriptions on assembly and prevention of accidents
- Possible existing visual monitoring devices, e.g. pressure gauges, MIN/MAX markings or piston detectors, must be clearly visible
- Observe prescriptions in chapter Technical data regarding the installation position

Place of installation

Protect the product against humidity, dust and vibrations and install it in an easily accessible position to facilitate other installation and maintenance works.

Mechanical connection

- Minimum assembly dimensions

Ensure sufficient space for maintenance work or for attachment of further components to build a centralized lubrication system to the pump by leaving a free space of at least 100 mm into each direction in addition to the stated dimensions.

**All the installation dimensions can be found on page 16.*

- Installation bores

Risk of damage to the superior machine and to the pump



Drill the mounting bores on non-loadbearing parts of the superior machine only. Fastening must not be done on two parts moving against one another (e. g. machine bed and machine assembly).

AUTOL

- Electrical connection

Electric shock



Make sure to disconnect the product from the power supply before carrying out any works on electrical components.

Carry out the electrical connection according to the connection type of the pump,

1. Tailor the line for the power supply according to the respective connection diagram in these instructions or use pre-fabricated cable. It is mandatory to use a backup fuse. Check on page 12!
2. In case the divider monitoring function is not needed on the pump, insert the BD protective cap 3030502160 into the BD socket and tighten it. Only by doing so the degree of protection (IP class) can be complied with.

- Mount pump element and safety valve

Generally, a standard pump has a set of pump element and safety valve (SV-C) on the left side of the pump outlet. To mounting an extra set of pump element and safety valve, please make sure, the pump has been disconnected from the power supply.

Tightening torque for pump element = 43 Nm +/- 2,0 Nm

Tightening torque for safety valve = 36 Nm +/- 2,0 Nm



Trouble shooting

Fault	Possible cause	Solution
Pump does not run	<ul style="list-style-type: none"> ▪ Power supply to pump interrupted <ul style="list-style-type: none"> – Superior machine is switched off – Connection cable of pump is loose or defective – External fuse is defective ▪ Pump is in the pause time mode ▪ Pump motor is defective ▪ Pump print board is defective ▪ Internal cable break 	<p>Check whether one of the indicated faults is present and remedy it in the frame of responsibilities.</p> <p>Faults outside of your own responsibility have to be reported to your superior to initiate further measures.</p> <p>If the fault cannot be determined and remedied, please contact our Customer Service</p>
Pump runs but supplies no or only little lubricant	<ul style="list-style-type: none"> ▪ Blockade, fault within the centralized lubrication system ▪ Grease level in reservoir under Min. level ▪ Defective non-retrun valve ▪ Defective safety valve ▪ Suction bore of pump element is clogged ▪ Close pump element ▪ Air bubbles in the pump body ▪ Too high lubricant consistency (at low temperatures) ▪ Too low lubricant consistency (at high temperatures) ▪ Wrong configuration of dividers 	<p>Check whether one of the indicated faults is present and remedy it in the frame of responsibilities.</p> <p>Faults outside of your own responsibility have to be reported to your superior to initiate further measures.</p> <p>If the fault cannot be determined and remedied, please contact our Customer Service</p>

* More details for EE-1 and EE-2 as the error code on pump display please check page 20 and 21.

Trouble shooting for the Blockade of a progressive pump

Possibilities for a blockade:

- Defect of pump element

Dismount the main hose from the pump and check the pressure of the manometer. The safety valve must open before the manometer reaches 250 - 300 bar.

If no manometer is available: dismount the inlet coupling in front of the main divider and check if grease is delivered.

- Defect motor / control unit

For pump with integrated controller, press the button "R" on the display and check if the motor rotates.

AUTOL

- Defect of the safety valve

Signal for a defected safety valve – the lubricant comes out from the safety valve.

Dismount the main hose from the outlet of the safety valve and use a blind plug on the outlet. Check the pressure of the manometer, if the safety valve opens under 180bar, replace the safety valve.

After all the above processes have been checked but no defects have been found, the further checking for the dividers need be done as well. More details for divider checking please check the trouble shooting of divider.

Important!



The repair work must be done under maximum cleanliness.

Shutdown and disposal



Temporary shutdown

Temporarily shut the system down by:

- Switching off the superior machine.
- Disconnecting the product from the power supply.

Final shutdown and disassembly

The final shutdown and disassembly of the product must be planned and carried out by the operator in a professional manner and in compliance with all regulations to be observed.

Disposal

- for Countries within the European Union

Disposal should be avoided or minimized wherever possible. Disposal of products contaminated with lubricant must be affected via licensed waste disposal contractor in accordance with environmental requirements and waste disposal regulations as well as local authority requirements.

The specific classification of the waste is in the waste producer's responsibility, as the European Waste Catalogue provides different waste disposal codes for the same type of waste but of different origin.

Electrical components have to be disposed of or recycled following WEEE directive 2012/19/EU.

Plastic or metal parts can be disposed of with the commercial waste.

- for Countries outside the European Union

The disposal must be done according to the valid national regulations and laws of the country where the product is used.

AUTOL

Order Key

ALPB - 1 - 101 4 - PE 2.5C - 0 - 0 - 0 - 1 - 0 - 1 - 0000

Motor Voltage	
12V	1
24V	2
230V	3

Type of Pump	
D170 Reservoir Stirring Paddle Type Pump (2,4L)	101
D230 Reservoir Stirring Paddle Type Pump (4,8,15,20L)	121
D230 Reservoir Spring Piston Type Pump (4,8,15L)	122
D314 Reservoir Spring Piston Type Pump (20,30L)	132

Size of Reservoir	
2L	2
4L	4
8L	8
15L	15
20L	20
30L	30

Pump Outlet M22 Configuration - Pos. 1/2/3/4				
	Pos.1	Pos.2	Pos.3	Pos.4
Blind Plug	0	0	0	0
PE 1.5 without Bypass	1.5C	1.5C	1.5C	1.5C
PE 1.5 with Bypass	1.5A	1.5A	1.5A	1.5A
PE 2.5 without Bypass	2.5C	2.5C	2.5C	2.5C
PE 2.5 with Bypass	2.5A	2.5A	2.5A	2.5A
PE 4.5 without Bypass	4.5C	4.5C	4.5C	4.5C
PE 4.5 with Bypass	4.5A	4.5A	4.5A	4.5A
Hand Press Adapter Straight		HP	HP	
Bypass Inlet				BP
Customized Setting	X	X	X	X

Standard PE Position 1

For pump element at least with 1 safety valve with bypass must have a bypass inlet on Pos.4

Pos.A - Power Connector	
Without any Power Cable (Bayonet Ver.)	0
With Hirschmann 3/4 Pin Cable 7.5m	1
With Bayonet 5/7 Pin Cable 7.5m(incl. Test Button and Status Light Function)	2

Pos.B - Divider Monitoring Connector (Signal input)
Please check our Divider manual and order with divider

Pos.C - Other connector (Signal input)	
Without any other cable (for Bayonet Ver. please keep Pos.C as)	0
With Test Button and Status Light Cable 5m (HSC Ver.)	1
With Test Button and Status Light Cable 7.5m (HSC Ver.)	2
With Lvl. Monitoring Output Cable 5m (HSC Ver.)	3
With Lvl. Monitoring Output Cable 7.5m (HSC Ver.)	4

Controller	
Without Integrated Controller	0
Without Standard Integrated Controller AK06	1

Special Models	
Standard Version	0000
Customized Version	XXXX

